

Wise County Texas 1940 Census

# Enumeration District 249-08

## Park Springs & Area Southeast

(Justice Precinct #3)

603 names on 9 pages - parts A and B

The 1940 enumerator was George W. King

Images of original handwritten pages are online at <http://www.wisecountytexas.info/census/1940.htm>

Transcriptions of select information by

Lynda Becker

Checked by Douglas Harris

(The information in brackets and parenthesis came from county records,  
comparison with the 1930 census, or personal knowledge)

Part of the 1940 census map showing the northern part of ED 08 (East of RR tracks & West of Big Sandy)

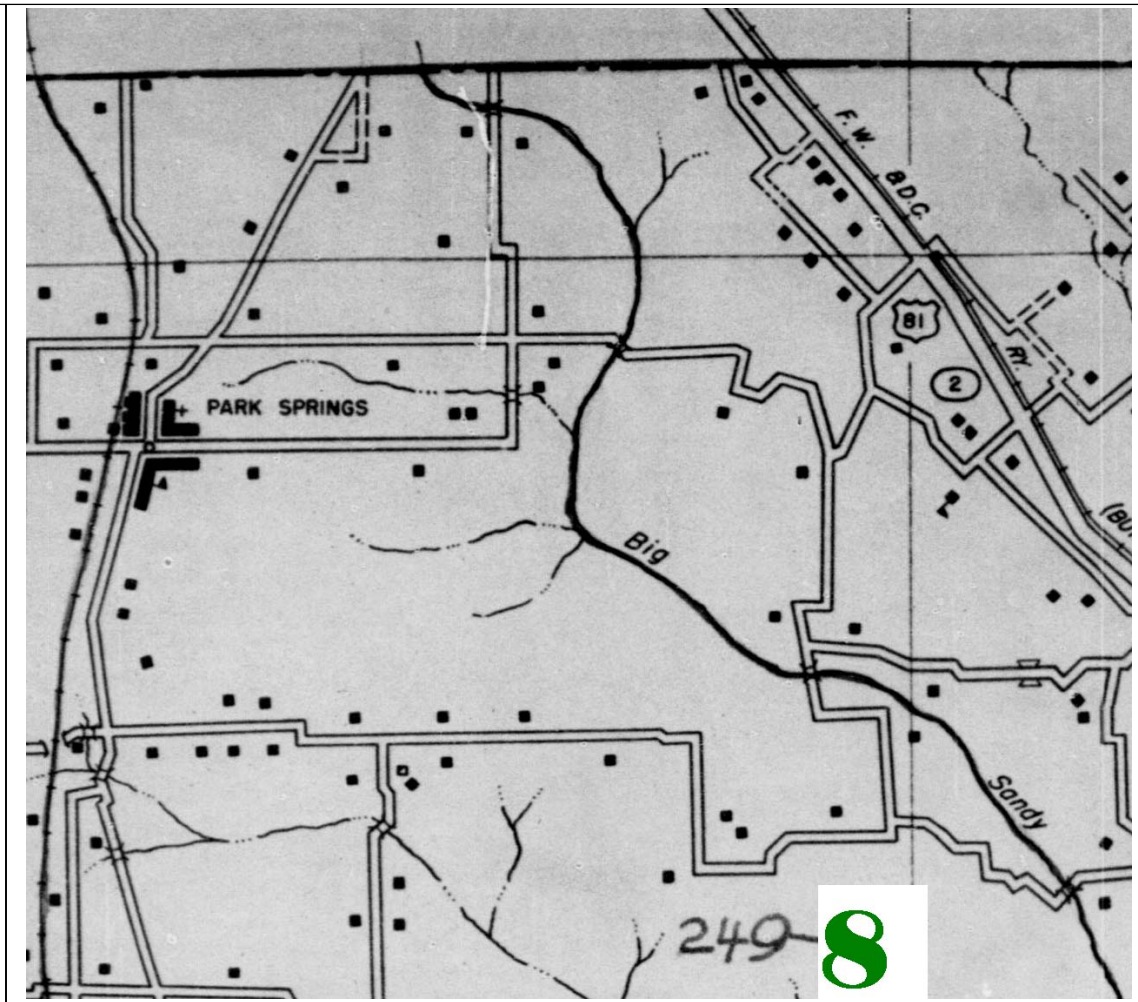

1940 census map showing the southern part of ED 08

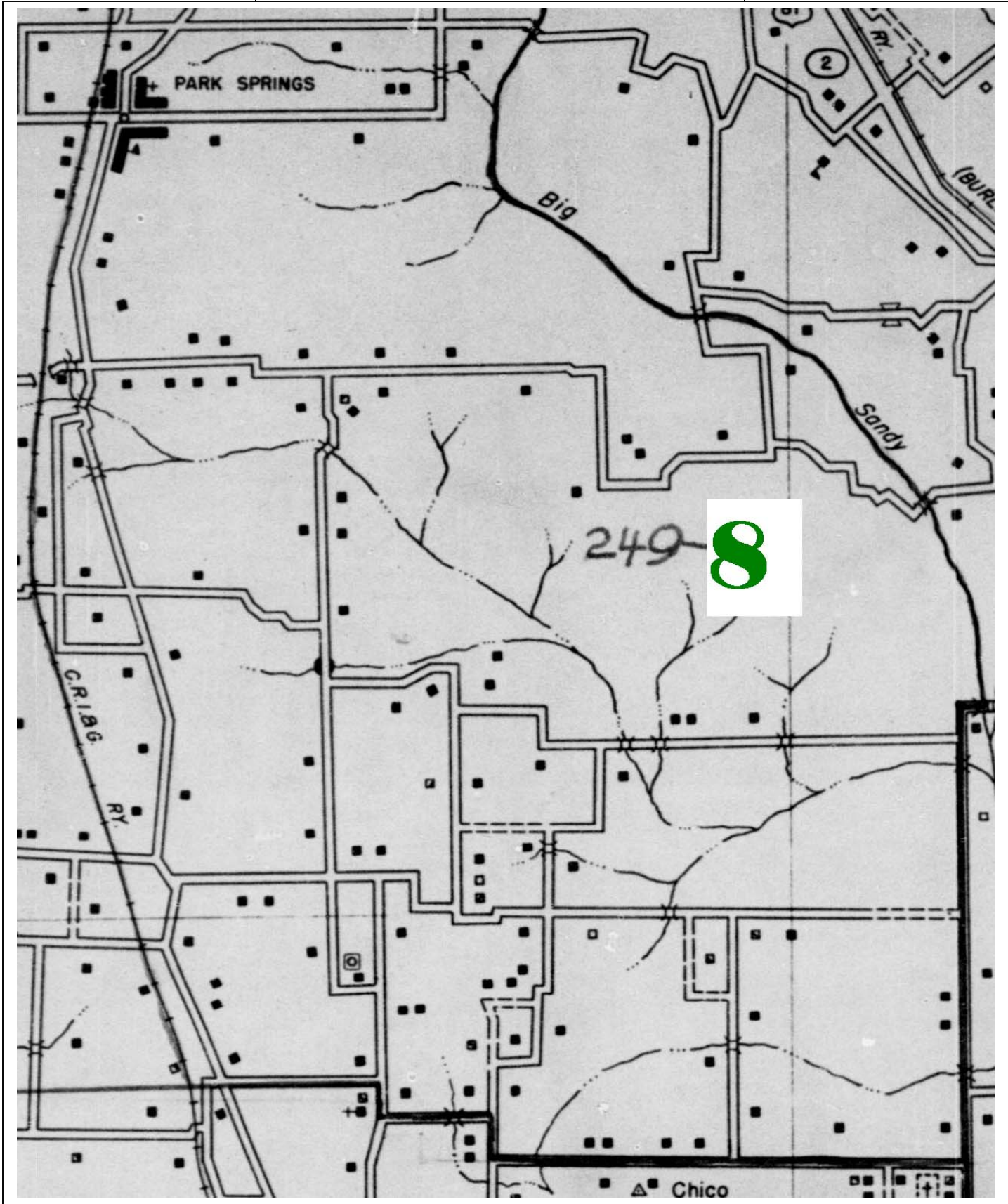

**1940 ED 08 Park Springs and Area Southeast**

ED	Page	Line	Location	Last Name	First Name [(Additional Information)]	Relation	Age	Occupation
08	01A	01	Park Springs & SE	Gann	George Y [Yeaklet]	head	48	farmer, farming
08	01A	02	Park Springs & SE	Gann	Sarah (DRENNAN)	wife	44	
08	01A	03	Park Springs & SE	Gann	G Y	son	15	
08	01A	04	Park Springs & SE	Watson	Wyett [Wyatt Stant]	head	44	PWA(WPA)road project
08	01A	05	Park Springs & SE	Watson	Letha (LYDA)	wife	38	
08	01A	06	Park Springs & SE	Watson	Lauranda [Lourenda/Lurline]	daughter	14	
08	01A	07	Park Springs & SE	Watson	Faye [Lillie Faye]	daughter	13	
08	01A	08	Park Springs & SE	Watson	Cue [Era Cue]	daughter	11	
08	01A	09	Park Springs & SE	Watson	Jesse [Jessie]	daughter	8	
08	01A	10	Park Springs & SE	Watson	Joyce [Joice/Joyce Beth]	daughter	2	
08	01A	11	Park Springs & SE	Smith	Geo W	head	75	farmer, farming
08	01A	12	Park Springs & SE	Smith	Jane	wife	69	
08	01A	13	Park Springs & SE	Odell	James P [Pat]	head	29	farmer, farming
08	01A	14	Park Springs & SE	Odell	Emma (GREEN)	wife	26	
08	01A	15	Park Springs & SE	Odell	Patsy [Ruth]	daughter	4	
08	01A	16	Park Springs & SE	Boner	Ben	head	49	labor, farming
08	01A	17	Park Springs & SE	Boner	Murtle [Myrtle (EDGE)]	wife	50	
08	01A	18	Park Springs & SE	Boner	John T	son	18	labor, farming
08	01A	19	Park Springs & SE	Boner	Odis	son	13	
08	01A	20	Park Springs & SE	Boner	Alvis [Benjamin]	son	13	
08	01A	21	Park Springs & SE	Edge	Maggie	m/law	79	
08	01A	22	Park Springs & SE	Smith	John P	head	67	farmer, farming
08	01A	23	Park Springs & SE	Stringer	Maggie D	head	68	gardening, farming
08	01A	24	Park Springs & SE	Belew	W D [William]	head	78	
08	01A	25	Park Springs & SE	Belew	Molly [T (MERRITT)]	wife	75	
08	01A	26	Park Springs & SE	Belew	Vaughn	son	32	labor, farming
08	01A	27	Park Springs & SE	Harrison	Jewel [Jewell]	head	26	labor, farming
08	01A	28	Park Springs & SE	Harrison	Calva [Merrion Calva (LYNCH)]	wife	21	
08	01A	29	Park Springs & SE	Ross	Orma (EDGE)	head	55	
08	01A	30	Park Springs & SE	Ross	John R	son	18	labor, PWA(WPA)project
08	01A	31	Park Springs & SE	Lasiter	Albert R	head	45	farmer, farming
08	01A	32	Park Springs & SE	Lasiter	Inez (JOHNSON)	wife	37	
08	01A	33	Park Springs & SE	Lasiter	Harold	son	17	
08	01A	34	Park Springs & SE	Lasiter	Donald	son	14	
08	01A	35	Park Springs & SE	Vain	George H	head	64	farmer, farming
08	01A	36	Park Springs & SE	Vain	Alice	wife	67	
08	01A	37	Park Springs & SE	Smith	Daniel E	head	62	farmer, farming
08	01A	38	Park Springs & SE	Smith	Katie	wife	48	
08	01A	39	Park Springs & SE	Smith	Daniel H	son	13	
08	01A	40	Park Springs & SE	McKeever	Elmer W [William]	head	26	labor, WPA project
08	01B	41	Park Springs & SE	McKeever	Evelene O (BONER)	wife	20	
08	01B	42	Park Springs & SE	McKeever	Raymond W [William]	son	1	
08	01B	43	Park Springs & SE	Harrison	Jesse	head	36	PWA(WPA)road project
08	01B	44	Park Springs & SE	Harrison	Julia O (WAYS)	wife	40	
08	01B	45	Park Springs & SE	Harrison	Norman	daughter	17	
08	01B	46	Park Springs & SE	Harrison	J D	son	14	
08	01B	47	Park Springs & SE	Harrison	J W	son	13	
08	01B	48	Park Springs & SE	Harrison	Louise	daughter	10	
08	01B	49	Park Springs & SE	Harrison	Billy J [Joe]	daughter	6	
08	01B	50	Park Springs & SE	Hollingsworth	James P	head	30	PWA(WPA)road project
08	01B	51	Park Springs & SE	Hollingsworth	Faye	wife	20	
08	01B	52	Park Springs & SE	Hollingsworth	Mary K	daughter	1	

**1940 ED 08 Park Springs and Area Southeast**

ED	Page	Line	Location	Last Name	First Name [(Additional Information)]	Relation	Age	Occupation
08	01B	53	Park Springs & SE	Hollingsworth	Frank M	father	66	
08	01B	54	Park Springs & SE	Jackson	Annie [Jewel (McMILLAN)?	head	55	
08	01B	55	Park Springs & SE	Jackson	Eddie	son	27	farm work, farm
08	01B	56	Park Springs & SE	Jackson	Grady	son	14	farming, farm
08	01B	57	Park Springs & SE	Jackson	Isay	son	13	
08	01B	58	Park Springs & SE	Jackson	Doyle	son	12	
08	01B	59	Park Springs & SE	Poteet	Roy	brother	30	farming, farm
08	01B	60	Park Springs & SE	O'Shields	May (WAKEMON)?	head	60	
08	01B	61	Park Springs & SE	O'Shields	M J	head (son?)	23	farming, farm
08	01B	62	Park Springs & SE	O'Shields	C J	son	23	
08	01B	63	Park Springs & SE	O'Shields	Carl	son	26	laborer, farm
08	01B	64	Park Springs & SE	Keeler	David A	head	70	labor, carpenter
08	01B	65	Park Springs & SE	Keeler	Luella	wife	62	
08	01B	66	Park Springs & SE	Keeler	David L	son	29	oilfield, construction
08	01B	67	Park Springs & SE	Keeler	Jack E	son	18	farmwork, farm
08	01B	68	Park Springs & SE	Keeler	Jesse E	son	17	
08	01B	69	Park Springs & SE	Keeler	Warren D	son	15	
08	01B	70	Park Springs & SE	Harclerode	William H	br/law	62	farm work, farm
08	01B	71	Park Springs & SE	Harclerode	Vera [May]	daughter	40	
08	01B	72	Park Springs & SE	Harclerode	Maxine	gr/dau	19	
08	01B	73	Park Springs & SE	Harclerode	Norma Lou	gr/dau	9	
08	01B	74	Park Springs & SE	Harclerode	Mary	gr/dau	8	
08	01B	75	Park Springs & SE	Harclerode	Shelby	grandson	6	
08	01B	76	Park Springs & SE	Harclerode	Jo	grandson	4	
08	01B	77	Park Springs & SE	Dubby	Charlie R	head	62	farming, farm
08	01B	78	Park Springs & SE	Dubby	Eva	wife	61	
08	01B	79	Park Springs & SE	Dubby	Jack	son	32	tire salesman fil/station
08	01B	80	Park Springs & SE	Cox	Jeff M	head	32	trucks, own truck
08	02A	01	Park Springs & SE	Cox	Ruby [Lee (HENSON)]	wife	35	
08	02A	02	Park Springs & SE	Cox	Jeff M	son	16	
08	02A	03	Park Springs & SE	Cox	Charles N	son	12	
08	02A	04	Park Springs & SE	Cox	Thomas E	son	9	
08	02A	05	Park Springs & SE	Cox	Eldon R	son	[6]	
08	02A	06	Park Springs & SE	Cox	Linda Faye	daughter	blank	
08	02A	07	Park Springs & SE	Denney	Walter D	head	57	farm, farming
08	02A	08	Park Springs & SE	Denney	Ora [Pearl (HEFNER)]	wife	55	
08	02A	09	Park Springs & SE	Denney	Irene	daughter	25	seamstress/WPA
08	02A	10	Park Springs & SE	Denney	Earnest E	son	20	farm, farming
08	02A	11	Park Springs & SE	Denney	Danie	daughter	18	
08	02A	12	Park Springs & SE	Eubanks	Tom D	head	63	farm, farming
08	02A	13	Park Springs & SE	Eubanks	Laura	wife	64	
08	02A	14	Park Springs & SE	Eubanks	Arnal	son	30	farm, farming
08	02A	15	Park Springs & SE	Eubanks	C J	son	8	
08	02A	16	Park Springs & SE	Eubanks	Mary	gr/dau	7	
08	02A	17	Park Springs & SE	May	Jack	son/law	41	drilling boss/construction
08	02A	18	Park Springs & SE	May	Alfa	daughter	35	
08	02A	19	Park Springs & SE	Davis	Rufus C [Carl]	head	43	laborer/PWA (WPA)
08	02A	20	Park Springs & SE	Davis	Tommie [Ann (COX)]	wife	43	
08	02A	21	Park Springs & SE	Davis	Herbert C	son	15	
08	02A	22	Park Springs & SE	Davis	Mildred	daughter	11	
08	02A	23	Park Springs & SE	Davis	Mary [Frances]	daughter	8	
08	02A	24	Park Springs & SE	Davis	James M [Melton]	son	5	

**1940 ED 08 Park Springs and Area Southeast**

ED	Page	Line	Location	Last Name	First Name [(Additional Information)]	Relation	Age	Occupation
08	02A	25	Park Springs & SE	Davis	Polly [June]	daughter	2	
08	02A	26	Park Springs & SE	Meek	Charles J [John Charles]	head	49	farm, farming
08	02A	27	Park Springs & SE	Meek	Emma (GUFFIN)	wife	47	
08	02A	28	Park Springs & SE	Meek	Lela	daughter	22	
08	02A	29	Park Springs & SE	Meek	Erma	daughter	18	
08	02A	30	Park Springs & SE	Meek	Grady [Lamond]	son	15	
08	02A	31	Park Springs & SE	Meek	Grace	daughter	15	
08	02A	32	Park Springs & SE	Meek	J C [John Charles, Jr?]	son	13	
08	02A	33	Park Springs & SE	Meek	Josie	mother	82	
08	02A	34	Park Springs & SE	Redwine	James C [Coy]	head	35	laborer/PWA (WPA)
08	02A	35	Park Springs & SE	Redwine	Dora [Merle (PICKENS)]	wife	32	
08	02A	36	Park Springs & SE	Redwine	Dorthory [Dorothe Marie]	daughter	10	
08	02A	37	Park Springs & SE	Redwine	Anita	daughter	2	
08	02A	38	Park Springs & SE	Flowers	Joseph [Gentry]	head	71	farm, farming
08	02A	39	Park Springs & SE	Flowers	Myrtle [Odela (MEADOR)]	wife	62	
08	02A	40	Park Springs & SE	Acker	Joseph F [Joe T]	head	43	laborer, farm
08	02B	41	Park Springs & SE	Acker	Ollie [Edna (SMITH)]	wife	30	
08	02B	42	Park Springs & SE	Acker	Grace	daughter	10	
08	02B	43	Park Springs & SE	Acker	Barbara [Barbra Joe]	daughter	5	
08	02B	44	Park Springs & SE	Acker	Betty Jane [Jean]	daughter	3	
08	02B	45	Park Springs & SE	Cowley	Aaron H [Hillery]	head	62	farm, farming
08	02B	46	Park Springs & SE	Cowley	Nanie [Nannie (SMITH)]	wife	55	
08	02B	47	Park Springs & SE	Watson	Charley [Charles Marvin]	head	27	farm, farming
08	02B	48	Park Springs & SE	Watson	Lorene [Faye (HUNTER)]	wife	23	
08	02B	49	Park Springs & SE	Watson	Kenneth	son	3	
08	02B	50	Park Springs & SE	Watson	Lawrence [Derrell]	son	1	
08	02B	51	Park Springs & SE	Gann	Datus N [Needem]	head	57	farm, farming
08	02B	52	Park Springs & SE	Gann	Lora N [Nell (TOMPKINS)]	wife	53	
08	02B	53	Park Springs & SE	Gann	Glenn G [Garvis]	son	25	laborer, oil field
08	02B	54	Park Springs & SE	Gann	Jennie [Lee]	daughter	18	
08	02B	55	Park Springs & SE	Barrett	Thomas R [Ragland]	head	38	farm, farming
08	02B	56	Park Springs & SE	Barrett	Nellie O [Nellie Alene (HALL)]	wife	32	
08	02B	57	Park Springs & SE	Barrett	Harold [Ray]	son	13	
08	02B	58	Park Springs & SE	Barrett	Weldon C [Cecil Weldon]	son	11	
08	02B	59	Park Springs & SE	Barrett	Erma [Ermal Mae]	daughter	5	
08	02B	60	Park Springs & SE	Barrett	T C [Thomas Columbus]	son	3	
08	02B	61	Park Springs & SE	Hall	May	mo/law	67	
08	02B	62	Park Springs & SE	Morrow	Vester S [Vester Scott]	head	41	farm, farming
08	02B	63	Park Springs & SE	Morrow	Murtle [Myrtle Adelia (CANTWELL)]	wife	42	
08	02B	64	Park Springs & SE	Morrow	Grady [William]	son	19	laborer, farm
08	02B	65	Park Springs & SE	Morrow	V L [Vester Luffin]	son	17	new worker
08	02B	66	Park Springs & SE	Morrow	Glinn [Edward]	son	14	
08	02B	67	Park Springs & SE	Meek	John [N]	head	26	bus driver, school bus
08	02B	68	Park Springs & SE	Meek	Chatherine [Catherine Estella (ROSS)]	wife	24	
08	02B	69	Park Springs & SE	Meek	Margrite [Margret Sue]	daughter	6	
08	02B	70	Park Springs & SE	Gumm	Billy L	nephew	13	
08	02B	71	Park Springs & SE	Walker	Otis F [Floyd]	head	34	laborer, WPA
08	02B	72	Park Springs & SE	Walker	Daisey [Opal (BLACKBURN/BLACKMON)]	wife	38	
08	02B	73	Park Springs & SE	Walker	Christine [Lavella Christine]	daughter	8	
08	02B	74	Park Springs & SE	Walker	Joyce [Larue]	daughter	5	
08	02B	75	Park Springs & SE	Walker	Bobby D [Robert Dean]	son	1	
08	02B	76	Park Springs & SE	Johnson	Rupert [Orris]	head	45	laborer, WPA

**1940 ED 08 Park Springs and Area Southeast**

ED	Page	Line	Location	Last Name	First Name [(Additional Information)]	Relation	Age	Occupation
08	02B	77	Park Springs & SE	Johnson	Mary	daughter	18	
08	02B	78	Park Springs & SE	Johnson	Binita	daughter	16	
08	02B	79	Park Springs & SE	Johnson	Ladetta	daughter	14	
08	02B	80	Park Springs & SE	Johnson	June [Ruby June]	daughter	12	
08	03A	01	Park Springs & SE	Robinson	Irwin L [Lamar]	head	70	farm, farming
08	03A	02	Park Springs & SE	Robinson	Maude D [Hizzie Maude (GULLEY)]	wife	65	
08	03A	03	Park Springs & SE	Robinson	Fred F	son	33	farm, farming
08	03A	04	Park Springs & SE	Lasiter	Thomas [Granville/Granvel]	head	75	farm, farming
08	03A	05	Park Springs & SE	Lasiter	Ida [Rosa Ida (GORE)]	wife	64	
08	03A	06	Park Springs & SE	Weatherly	George W [Washington]	head	56	farm, farming
08	03A	07	Park Springs & SE	Weatherly	Ethel (GALMER)	wife	46	
08	03A	08	Park Springs & SE	Weatherly	Ellis	daughter	31	farm, farming
08	03A	09	Park Springs & SE	Weatherly	Clem	daughter	29	farm, farming
08	03A	10	Park Springs & SE	Weatherly	Milson	daughter	21	laborer, farming
08	03A	11	Park Springs & SE	Weatherly	Robert	son	20	labor, farm
08	03A	12	Park Springs & SE	Weatherly	Harvey L	son	19	laborer, CCE
08	03A	13	Park Springs & SE	Weatherly	Irene	daughter	17	
08	03A	14	Park Springs & SE	Weatherly	Herman	son	16	
08	03A	15	Park Springs & SE	Weatherly	Mabel	daughter	14	
08	03A	16	Park Springs & SE	Weatherly	Ruby	daughter	11	
08	03A	17	Park Springs & SE	Weatherly	James	son	9	
08	03A	18	Park Springs & SE	Griffith	Geo W	head	85	farm, farming
08	03A	19	Park Springs & SE	Griffith	Nannie M	wife	80	
08	03A	20	Park Springs & SE	Buckner	Ernest E [Eugene, Sr.]	head	39	laborer, pipeline welder
08	03A	21	Park Springs & SE	Buckner	Iva [Mae (ALEXANDER)]	wife	37	
08	03A	22	Park Springs & SE	Buckner	Orell	son	15	
08	03A	23	Park Springs & SE	Buckner	Ernest E Jr [Eugene]	son	14	
08	03A	24	Park Springs & SE	Buckner	Virginia	daughter	13	
08	03A	25	Park Springs & SE	Buckner	Buford	son	9	
08	03A	26	Park Springs & SE	Buckner	Herman	son	6	
08	03A	27	Park Springs & SE	Buckner	Betty Jo [Bettie Joe]	daughter	3	
08	03A	28	Park Springs & SE	Tally	David P	head	61	farm, farming
08	03A	29	Park Springs & SE	Tally	Francis	wife	53	
08	03A	30	Park Springs & SE	Henton	James W [Walter]	head	58	farm, farming
08	03A	31	Park Springs & SE	Henton	Frankie [Edith Frances (MOWERY)]	wife	53	
08	03A	32	Park Springs & SE	Henton	Robert M	son	17	
08	03A	33	Park Springs & SE	Henton	Vernon R [Ray]	son	10	
08	03A	34	Park Springs & SE	Sherrod	Clint C [Clinton L]	head	51	laborer, farm
08	03A	35	Park Springs & SE	Stone	Frankie	head	54	farm, farming
08	03A	36	Park Springs & SE	Stone	Barbarie	wife	50	
08	03A	37	Park Springs & SE	Stone	Orell	son	15	
08	03A	38	Park Springs & SE	Stone	Roy B	son	22	care/horses, mule barn
08	03A	39	Park Springs & SE	Carver	Fred I	head	45	
08	03A	40	Park Springs & SE	Carver	Stella [Mae (CHOATE)]	wife	39	
08	03B	41	Park Springs & SE	Carver	Daron	son	14	
08	03B	42	Park Springs & SE	Carver	Howard J	son	12	
08	03B	43	Park Springs & SE	Carver	Norma L	daughter	11	
08	03B	44	Park Springs & SE	Carver	Ruthie	daughter	10	
08	03B	45	Park Springs & SE	Carver	Maurice [Stella Maurice]	daughter	8	
08	03B	46	Park Springs & SE	Carver	Joyce [Neelia Joyce]	daughter	7	
08	03B	47	Park Springs & SE	Carver	Johnnie [Wilburn]	daughter (son)	4	
08	03B	48	Park Springs & SE	Carver	Bennie	daughter	2	

**1940 ED 08 Park Springs and Area Southeast**

ED	Page	Line	Location	Last Name	First Name [(Additional Information)]	Relation	Age	Occupation
08	03B	49	Park Springs & SE	Whitaker	Josh [Joshua N]	head	44	farm, farming
08	03B	50	Park Springs & SE	Whitaker	Ione (RANEY)	wife	40	
08	03B	51	Park Springs & SE	Whitaker	Daisy Ann	daughter	14	
08	03B	52	Park Springs & SE	Caruthers	William M	head	53	farm, farming
08	03B	53	Park Springs & SE	Caruthers	Nora	wife	46	
08	03B	54	Park Springs & SE	Caruthers	Martha J	daughter	22	teacher, public school
08	03B	55	Park Springs & SE	Caruthers	Doris	daughter	18	
08	03B	56	Park Springs & SE	Huggins	Henry W [Waterloo]	head	65	labor, farm
08	03B	57	Park Springs & SE	Huggins	Alice [Geneva Alice (BOYDSTON)]	wife	64	labor, farm
08	03B	58	Park Springs & SE	Huggins	Ruby	son	40	labor, farm
08	03B	59	Park Springs & SE	Huggins	Oral [Oscar]	son	33	labor, farm
08	03B	60	Park Springs & SE	Huggins	Joyce	gr/dau	27	labor, farm
08	03B	61	Park Springs & SE	Huggins	Oran W	grandson	23	
08	03B	62	Park Springs & SE	Huggins	Lorene	gr/dau	18	
08	03B	63	Park Springs & SE	Huggins	Flora F	grandson	16	
08	03B	64	Park Springs & SE	Huggins	Lou	gr/dau	14	
08	03B	65	Park Springs & SE	Glass	Albert B [Brice, Sr.]	head	56	farming, farm
08	03B	66	Park Springs & SE	Glass	Mabel [Dessie Mable (SAUNDERS)]	wife	30	
08	03B	67	Park Springs & SE	Glass	Albert, Jr [Brice]	son	4	
08	03B	68	Park Springs & SE	Raney	Sam C	head	77	farming, farm
08	03B	69	Park Springs & SE	Raney	Molly [Mollie V]	wife	68	
08	03B	70	Park Springs & SE	Raney	Joe B	son	38	farming, farm
08	03B	71	Park Springs & SE	Ford	Jake	head	27	farming, farm
08	03B	72	Park Springs & SE	Ford	Frances [Ardella (ALEXANDER)]	wife	25	
08	03B	73	Park Springs & SE	Ford	Billy Ray	son	5	
08	03B	74	Park Springs & SE	Ford	Winford [Royce]	son	1	
08	03B	75	Park Springs & SE	Ford	J B	father	54	
08	03B	76	Park Springs & SE	Buckner	Willie F [William Franklin]	head	43	farming, farm
08	03B	77	Park Springs & SE	Buckner	Lara [Lura Belle (HOLTZCLAW)]	wife	39	
08	03B	78	Park Springs & SE	Buckner	Gerldine	daughter	19	
08	03B	79	Park Springs & SE	Buckner	Bobby	son	9	
08	03B	80	Park Springs & SE	McGee	Leather [Odell]	head	26	farming, farm
08	04A	01	Park Springs & SE	McGee	Juanita	wife	22	
08	04A	02	Park Springs & SE	Moore	J D	bro/law	17	laborer, farm
08	04A	03	Park Springs & SE	Buckner	George R [Riley]	head	71	laborer, farm
08	04A	04	Park Springs & SE	Buckner	Ada L [Lee (LITTLEFIELD)]	wife	64	
08	04A	05	Park Springs & SE	Thornhill	Hubert A	head	25	farmer, farm
08	04A	06	Park Springs & SE	Thornhill	Sybil	wife	20	
08	04A	07	Park Springs & SE	Thornhill	Wanda Lou	daughter	2	
08	04A	08	Park Springs & SE	Bailey	B W	head	53	farming, farm
08	04A	09	Park Springs & SE	Bailey	Ida	wife	45	
08	04A	10	Park Springs & SE	Bailey	Vel	son	18	farm, farming
08	04A	11	Park Springs & SE	Bailey	Jack	son	16	
08	04A	12	Park Springs & SE	Bailey	Leroy	son	11	
08	04A	13	Park Springs & SE	Briley	Walter L	head	50	laborer, PWA (WPA)
08	04A	14	Park Springs & SE	Briley	Vidia (MONTGOMERY)	wife	43	
08	04A	15	Park Springs & SE	Briley	Arno	son	21	farm, farming
08	04A	16	Park Springs & SE	Briley	Norville	son	10	
08	04A	17	Park Springs & SE	Montgomery	Ellen	mo/law	66	
08	04A	18	Park Springs & SE	Montgomery	Chatherine	sis/law	22	
08	04A	19	Park Springs	Greeson	Charley W	head	80	
08	04A	20	Park Springs	McGee	Lorena [Wella (SMITH)]	daughter	31	

**1940 ED 08 Park Springs and Area Southeast**

ED	Page	Line	Location	Last Name	First Name [(Additional Information)]	Relation	Age	Occupation
08	04A	21	Park Springs	McGee	Eloise	gr/dau	3	
08	04A	22	Park Springs	Daniel	William F [Franklin]	head	45	laborer, railroad
08	04A	23	Park Springs	Daniel	Donie V [Viola (HOLLINGSWORTH)]	wife	44	
08	04A	24	Park Springs	Daniel	Dorthory M	daughter	12	
08	04A	25	Park Springs	Daniel	William E [Walter]	son	8	
08	04A	26	Park Springs	Hollingsworth	Frank	father/law	66	
08	04A	27	Park Springs	Hamilton	Jack F	worker	37	laborer, farm
08	04A	28	Park Springs	Brown	Ella	head	61	
08	04A	29	Park Springs	Appling	Geneva	sister	62	
08	04A	30	Park Springs	McDonald	Anna	head	53	
08	04A	31	Park Springs	Badgenell	William	nephew	18	laborer, CCC
08	04A	32	Park Springs	Dart	William H [Henry]	head	71	
08	04A	33	Park Springs	Dart	Anna [Elizabeth (HAMILTON)]	wife	54	
08	04A	34	Park Springs	Dart	Thurmond	son	29	
08	04A	35	Park Springs	Dart	J C [Clifford?]	son	20	laborer, CCC
08	04A	36	Park Springs	Dart	Ruth	daughter	17	
08	04A	37	Park Springs	Dart	Jewel	daughter	17	
08	04A	38	Park Springs	Dart	Barbara [Jean]	daughter	15	
08	04A	39	Park Springs	Dart	Pat	daughter	13	
08	04A	40	Park Springs	Dart	Betty Jo	daughter	11	
08	04B	41	Park Springs & SE	McKay	Lula	head	74	
08	04B	42	Park Springs & SE	Tipton	Elbert	brother	79	
08	04B	43	Park Springs & SE	Tipton	Glen C	nephew	35	laborer, oil crew
08	04B	44	Park Springs & SE	Wortman	Cora	head	48	
08	04B	45	Park Springs & SE	Wortman	Peral	sister	31	laborer, farm
08	04B	46	Park Springs & SE	Walker	Carl E [Edwin, Sr.]	head	29	laborer, PWA(WPA)
08	04B	47	Park Springs & SE	Walker	Bessie [Maude (HOLLINGSWORTH)]	wife	31	
08	04B	48	Park Springs & SE	Walker	Carl E Jr [Edwin]	son	10	
08	04B	49	Park Springs & SE	Walker	Callie	daughter	8	
08	04B	50	Park Springs & SE	Walker	Viola Fay	daughter	2/12	
08	04B	51	Park Springs & SE	Workman	Wes W [Wesley Walter]	head	48	laborer, PWA(WPA)
08	04B	52	Park Springs & SE	Workman	Laura [Bell (STEWART)]	wife	41	
08	04B	53	Park Springs & SE	Workman	Ralph H	son	18	
08	04B	54	Park Springs & SE	Mitchum	Jack M [Jackson]	head	64	laborer, farm
08	04B	55	Park Springs & SE	Mitchum	Ella [Ellen Olivia (HURDT)]	wife	62	
08	04B	56	Park Springs & SE	Dobbs	Delois [Marie]	gr/dau	9	
08	04B	57	Park Springs & SE	Herren	Joseph S	head	65	laborer, PWA(WPA)
08	04B	58	Park Springs & SE	Herren	Viola Fay	wife	38	
08	04B	59	Park Springs & SE	Herren	Estogo	daughter	14	
08	04B	60	Park Springs & SE	Walker	Henry S	head	67	blacksmith, own shop
08	04B	61	Park Springs & SE	McKinney	Frank	head	47	laborer, railroad
08	04B	62	Park Springs & SE	McKinney	Georgia	sister	40	postmistress, post office
08	04B	63	Park Springs & SE	Appling	Mamie	sister	38	
08	04B	64	Park Springs & SE	Appling	Laymon	nephew	16	
08	04B	65	Park Springs & SE	Appling	Billy Gene	nephew	14	
08	04B	66	Park Springs & SE	Randall	Harvey B	head	50	laborer, PWA(WPA)
08	04B	67	Park Springs & SE	Randall	Minnie [S (SMITH)]	wife	44	
08	04B	68	Park Springs & SE	Randall	Wilburn	son	26	laborer, railroad
08	04B	69	Park Springs & SE	Randall	Harvey W	son	24	laborer, railroad
08	04B	70	Park Springs & SE	Randall	Pauline J	daughter	21	
08	04B	71	Park Springs & SE	Ritchie	Adam	head	70	
08	04B	72	Park Springs & SE	Ritchie	Clarence [Darrell]	son	27	new worker



**1940 ED 08 Park Springs and Area Southeast**

ED	Page	Line	Location	Last Name	First Name [(Additional Information)]	Relation	Age	Occupation
08	04B	73	Park Springs & SE	Ritchie	Ruby [Clara (COX)]	dau/law	23	
08	04B	74	Park Springs & SE	Ritchie	Cynthia Ann	gr/dau	6/12	
08	05A	01	Park Springs & SE	Gann	James C [Chester]	head	81	
08	05A	02	Park Springs & SE	Gann	Susie E [Susan Elizabeth (COATES)]	wife	81	
08	05A	03	Park Springs & SE	Wright	Mazell	house kp	18	
08	05A	04	Park Springs & SE	Richey	Albert	head	33	trading, trader/livestock
08	05A	05	Park Springs & SE	Richey	Cleta [Bell (SETSER)]	wife	23	
08	05A	06	Park Springs & SE	Richey	Kenneth W [Wayne]	son	2	
08	05A	07	Park Springs & SE	Moore	Edward R	head	54	laborer, WPA school project
08	05A	08	Park Springs & SE	Moore	Beatrice [O (WALKER)]	wife	47	
08	05A	09	Park Springs & SE	Moore	Viola	daughter	28	
08	05A	10	Park Springs & SE	Moore	Claude	son	24	laborer, farm
08	05A	11	Park Springs & SE	Moore	Willie Opal	daughter	17	
08	05A	12	Park Springs & SE	Moore	Kenneth R	son	14	
08	05A	13	Park Springs & SE	Moore	Anna Sue [Annie]	daughter	9	
08	05A	14	Park Springs & SE	Moore	Bobby Jo [Bobbie]	daughter	6	
08	05A	15	Park Springs & SE	Walker	Sue	mo/law	87	
08	05A	16	Park Springs & SE	Lancaster	Jack	son/law	29	laborer, farm
08	05A	17	Park Springs & SE	Lancaster	Irene (MOORE)	daughter	19	
08	05A	18	Park Springs & SE	Lancaster	Cecil [Wayne]	gr/dau	6/12	
08	05A	19	Park Springs & SE	Davis	William J [Jonathan]	head	69	
08	05A	20	Park Springs & SE	Davis	May [Janie May (STALMAKER)]	wife	60	
08	05A	21	Park Springs & SE	Watson	Vernon E	head	30	farming, farm
08	05A	22	Park Springs & SE	Watson	Beatrice	wife	24	
08	05A	23	Park Springs & SE	Watson	Betty Jean	daughter	3	
08	05A	24	Park Springs & SE	Watson	Lynn	brother	35	
08	05A	25	Park Springs & SE	Robinson	Elmer	head	45	laborer, farm
08	05A	26	Park Springs & SE	Robinson	Sarah (RICH)	wife	38	
08	05A	27	Park Springs & SE	Robinson	Rich	son	18	
08	05A	28	Park Springs & SE	Wortman	Avery W [Jackson]	head	38	farming, farm
08	05A	29	Park Springs & SE	Wortman	Willie [Lizzie (HUCKABEE)]	wife	37	
08	05A	30	Park Springs & SE	Price	William E	head	50	farming, farm
08	05A	31	Park Springs & SE	Price	Elizebeth	wife	42	
08	05A	32	Park Springs & SE	Whetsell	Ed W	head	56	farming, farm
08	05A	33	Park Springs & SE	Whetsell	Murtle E	wife	50	
08	05A	34	Park Springs & SE	Whetsell	Opal	daughter	16	
08	05A	35	Park Springs & SE	Buckner	Luther L [Lee]	head	36	farming, farm
08	05A	36	Park Springs & SE	Buckner	Beulah (HERRIOTT)	wife	35	
08	05A	37	Park Springs & SE	Buckner	Harlen [Harland Lee]	son	12	
08	05A	38	Park Springs & SE	Buckner	Marshall [Ray]	son	8	
08	05A	39	Park Springs & SE	Buckner	Dorthory	daughter	6	
08	05A	40	Park Springs & SE	Buckner	Calvin [Dee]	son	4	
08	05B	41	Park Springs & SE	Underwood	Walter N [Norman]	head	54	cream maker/Braum factory
08	05B	42	Park Springs & SE	Underwood	Bell [Belle (SHURBERT)]	wife	50	
08	05B	43	Park Springs & SE	Underwood	Howard	son	23	cream maker/Braum factory
08	05B	44	Park Springs & SE	Underwood	Aleta	daughter	18	
08	05B	45	Park Springs & SE	Underwood	Fannie (SMITH)	mother	72	
08	05B	46	Park Springs & SE	Walker	Henry L	head	23	mechanic repair shop
08	05B	47	Park Springs & SE	Walker	Nena	wife	23	
08	05B	48	Park Springs & SE	Walker	Charles L	son	3	
08	05B	49	Park Springs & SE	Smith	Thomas A	head	69	farming, farm
08	05B	50	Park Springs & SE	Smith	Peallie	daughter	37	

**1940 ED 08 Park Springs and Area Southeast**

ED	Page	Line	Location	Last Name	First Name [(Additional Information)]	Relation	Age	Occupation
08	05B	51	Park Springs & SE	Smith	Virgil	son	34	farming, farm
08	05B	52	Park Springs & SE	Smith	Artie	son	31	
08	05B	53	Park Springs & SE	Wortman	Green W	head	36	laborer PWA(WPA)
08	05B	54	Park Springs & SE	Wortman	Opal (PYEATT)	wife	30	
08	05B	55	Park Springs & SE	Wortman	Finis M	son	3	
08	05B	56	Park Springs & SE	Pyeatt	M C [Mary]	mo/law	75	
08	05B	57	Park Springs & SE	Scales	Tom B [Tommie]	head	50	farming, farm
08	05B	58	Park Springs & SE	Scales	Iva [May (EVANS) ]	wife	45	
08	05B	59	Park Springs & SE	Taylor	Frank E [Eugene]	head	60	farming, farm
08	05B	60	Park Springs & SE	Taylor	Rosie [Rosa Mary]	wife	58	
08	05B	61	Park Springs & SE	McGee	Francis M	head	28	farming, farm
08	05B	62	Park Springs & SE	McGee	Ruth O (HARDEE)	wife	25	
08	05B	63	Park Springs & SE	McGee	Francis M	son	4	
08	05B	64	Park Springs & SE	McGee	Bobby E	son	0/12	
08	05B	65	Park Springs & SE	Culverhouse	Willie F	head	50	farming, farm
08	05B	66	Park Springs & SE	Culverhouse	Bettie	wife	37	
08	05B	67	Park Springs & SE	Culverhouse	John D	father	78	
08	05B	68	Park Springs & SE	Williams	E N	lodger	80	
08	05B	69	Park Springs & SE	Able	Carrol F [Caroll F]	head	27	janitor, public school
08	05B	70	Park Springs & SE	Able	Watin V [Verline (LOVE)]	wife	27	
08	05B	71	Park Springs & SE	Able	Carrolyn	daughter	1	
08	05B	72	Park Springs & SE	Hayar	Lester	boarder	31	teacher, public school
08	05B	73	Park Springs & SE	Musgrove	Sebe R [Seborn/Sebron Rosco]	head	64	grocery man, own store
08	05B	74	Park Springs & SE	Musgrove	Connie [Pearl (WHITE)]	wife	60	
08	05B	75	Park Springs & SE	Martin	Edna	head	44	
08	05B	76	Park Springs & SE	Sands	Henritta	boarder	22	teacher, public school
08	05B	77	Park Springs & SE	Belew	William H	head	26	teacher, public school
08	05B	78	Park Springs & SE	Belew	Betty Jean	wife	27	teacher, public school
08	05B	79	Park Springs & SE	Belew	Betty Jean	daughter	1	
08	05B	80	Park Springs & SE	Sharp	Cora	aunt	59	maid, private home
08	06A	29	Park Springs & SE	Chadwick	William J [Jewel]	head	32	laborer, railroad
08	06A	30	Park Springs & SE	Chadwick	Opal R [Ruth (MONROE)]	wife	23	
08	06A	31	Park Springs & SE	Chadwick	Gerald W [Wallace]	son	3	
08	06A	32	Park Springs & SE	Chesser	Ollie	head	48	
08	06A	33	Park Springs & SE	Chesser	Claudie	daughter	21	
08	06A	34	Park Springs & SE	Anderson	James A	head	50	laborer, WPA road project
08	06A	35	Park Springs & SE	Anderson	Effie	wife	49	
08	06A	36	Park Springs & SE	Anderson	Euric	son	10	
08	06A	37	Park Springs & SE	Chadwick	James N	head	51	farming, farm
08	06A	38	Park Springs & SE	Chadwick	Srah	wife	58	
08	06A	39	Park Springs & SE	Alexander	Wright R	head	57	farming, farm
08	06A	40	Park Springs & SE	Alexander	Dora [May (WHITE)]	wife	60	
08	06B	41	Park Springs & SE	Alexander	Floyd E	son	16	
08	06B	42	Park Springs & SE	Alexander	Lucile [Joy]	daughter	14	
08	06B	43	Park Springs & SE	Huckabee	James M [Monroe, Jr]	head	31	farming, farm
08	06B	44	Park Springs & SE	Huckabee	Rebby (HAMILTON)	wife	27	
08	06B	45	Park Springs & SE	Huckabee	Evelyn	daughter	3	
08	06B	46	Park Springs & SE	Huckabee	Nolan	son	11/12	
08	06B	47	Park Springs & SE	McKay	Mary [Elizabeth (BUCKNER)]	head	45	shedding room WPA project
08	06B	48	Park Springs & SE	McKay	Lee B [Boyce]	son	16	
08	06B	49	Park Springs & SE	Buckner	Henry [Harvey]	head	68	farming, farm
08	06B	50	Park Springs & SE	Buckner	M M [Missouri May (BROWNING)]	wife	61	
08	06B	51	Park Springs & SE	Buckner	Jess	head	50	
08	06B	52	Park Springs & SE	Buckner	Bessie (DICKSON)	wife	47	

**1940 ED 08 Park Springs and Area Southeast**

ED	Page	Line	Location	Last Name	First Name [(Additional Information)]	Relation	Age	Occupation
08	06B	53	Park Springs & SE	<b>Buckner</b>	Elsie	daughter	15	
08	06B	54	Park Springs & SE	<b>Buckner</b>	Roy	son	13	
08	06B	55	Park Springs & SE	<b>Buckner</b>	Cecil	son	11	
08	06B	56	Park Springs & SE	<b>Buckner</b>	Wayne	son	9	
08	06B	57	Park Springs & SE	<b>Buckner</b>	James	son	7	
08	06B	58	Park Springs & SE	<b>Smith</b>	Milton H	head	58	farming, farm
08	06B	59	Park Springs & SE	<b>Smith</b>	Maggie	wife	50	
08	06B	60	Park Springs & SE	<b>Smith</b>	Guy	son	28	farming, farm
08	06B	61	Park Springs & SE	<b>Robinson</b>	Dick [Richard]	head	70	farming, farm
08	06B	62	Park Springs & SE	<b>Robinson</b>	Lillian (KILLOUGH)	wife	50	
08	06B	63	Park Springs & SE	<b>Robinson</b>	Richard K	son	17	farming, farm
08	06B	64	Park Springs & SE	<b>Robinson</b>	Doris Y	daughter	15	
08	06B	65	Park Springs & SE	<b>Robinson</b>	Robbie [Bobbie Jean]	daughter	12	
08	06B	66	Park Springs & SE	<b>McGee</b>	Ira L	head	55	farming, farm
08	06B	67	Park Springs & SE	<b>McGee</b>	Emily	wife	50	
08	06B	68	Park Springs & SE	<b>McGee</b>	Ineza	daughter	21	
08	06B	69	Park Springs & SE	<b>McGee</b>	Bonnie	daughter	21	
08	06B	70	Park Springs & SE	<b>McGee</b>	Elbert L	head	56	farming, farm
08	06B	71	Park Springs & SE	<b>McGee</b>	Clara [Mae (O'BRIEN)]	wife	48	
08	06B	72	Park Springs & SE	<b>McGee</b>	Joy Lee [Lea]	daughter	16	
08	06B	73	Park Springs & SE	<b>Whatley</b>	Joe Ben	head	29	laborer, WPA road project
08	06B	74	Park Springs & SE	<b>Whatley</b>	Oveta [Roberta (ALEXANDER)]	wife	21	
08	06B	75	Park Springs & SE	<b>Whatley</b>	Bertie Faye	daughter	4	
08	06B	76	Park Springs & SE	<b>Whatley</b>	Bernice [Vernise Eugene?]	daughter	1	
08	06B	77	Park Springs & SE	<b>Whatley</b>	Maretta	mother	65	
08	07A	01	Park Springs & SE	<b>Marlette</b>	Truman	head	20	laborer, farm
08	07A	02	Park Springs & SE	<b>Marlette</b>	Mireal	wife	17	
08	07A	03	Park Springs & SE	<b>Mara</b>	John E [Edward]	head	40	farm, farming
08	07A	04	Park Springs & SE	<b>Mara</b>	Pearl (McGUIRE)	wife	38	
08	07A	05	Park Springs & SE	<b>Mara</b>	Bobby [Travis]	son	19	new worker
08	07A	06	Park Springs & SE	<b>Mara</b>	Donellin [Doris Donella]	daughter	13	
08	07A	07	Park Springs & SE	<b>Mara</b>	Raymond [Bailey]	son	6	
08	07A	08	Park Springs & SE	<b>Wortman</b>	Frank [Robert Frank]	head	40	laborer, WPA
08	07A	09	Park Springs & SE	<b>Wortman</b>	Vera [Alice (PARKER)]	wife	35	
08	07A	10	Park Springs & SE	<b>Wortman</b>	Cecil	son	16	
08	07A	11	Park Springs & SE	<b>Wortman</b>	Raymond	son	14	
08	07A	12	Park Springs & SE	<b>Wortman</b>	Mildred	daughter	12	
08	07A	13	Park Springs & SE	<b>Wortman</b>	Doris [La Verne]	daughter	10	
08	07A	14	Park Springs & SE	<b>Wortman</b>	Christine	daughter	7	
08	07A	15	Park Springs & SE	<b>Huckabee</b>	Edd H [Haines 'Chick']	head	34	farm, farming
08	07A	16	Park Springs & SE	<b>Huckabee</b>	Doris [Elizabeth (POWERS)]	wife	24	
08	07A	17	Park Springs & SE	<b>Huckabee</b>	Joette	daughter	4	
08	07A	18	Park Springs & SE	<b>Huckabee</b>	Eddie E	son	3	
08	07A	19	Park Springs & SE	<b>Huckabee</b>	Peggy Ann	daughter	6/12	
08	07A	20	Park Springs & SE	<b>Coates</b>	William	head	50	farm, farming
08	07A	21	Park Springs & SE	<b>McLane</b>	Geo A	head	42	farm, farming
08	07A	22	Park Springs & SE	<b>McLane</b>	Edith	wife	30	
08	07A	23	Park Springs & SE	<b>McLane</b>	James	son	5	
08	07A	24	Park Springs & SE	<b>Phillips</b>	Harim	head	43	farm, farming
08	07A	25	Park Springs & SE	<b>Phillips</b>	Lee	father	70	farm, farming
08	07A	26	Park Springs & SE	<b>Phillips</b>	Allie	sister	44	
08	07A	27	Park Springs & SE	<b>Houston</b>	J W [James Walter]	head	60	farm, farming
08	07A	28	Park Springs & SE	<b>Houston</b>	Rachie [Rachel May (McDONALD)]	wife	48	
08	07A	29	Park Springs & SE	<b>Houston</b>	Weldon	son	20	

**1940 ED 08 Park Springs and Area Southeast**

ED	Page	Line	Location	Last Name	First Name [(Additional Information)]	Relation	Age	Occupation
08	07A	30	Park Springs & SE	Houston	Laren	daughter	17	
08	07A	31	Park Springs & SE	Manzingo	Alexander	head	63	farm, farming
08	07A	32	Park Springs & SE	Grulich	Adolph	head	30	labor, farming
08	07A	33	Park Springs & SE	Rhodes	Flossie	head	50	farm, farming
08	07A	34	Park Springs & SE	Thomas	Ira E [Ike]	head	58	farm, farming
08	07A	35	Park Springs & SE	Thomas	Cora (McMILLEN)	wife	54	
08	07A	36	Park Springs & SE	Thomas	Fern	daughter	21	
08	07A	37	Park Springs & SE	Richardson	J I	head	66	farm, farming
08	07A	38	Park Springs & SE	Richardson	Annis	wife	53	
08	07B	41	Park Springs & SE	Murphy	William	head	40	farm, farming
08	07B	42	Park Springs & SE	Murphy	Alice	wife	38	
08	07B	43	Park Springs & SE	Murphy	Margrette	daughter	9	
08	07B	44	Park Springs & SE	Murphy	Jean	daughter	7	
08	07B	45	Park Springs & SE	Murphy	Carol	daughter	3	
08	07B	46	Park Springs & SE	Murphy	Billy	son	1	
08	07B	47	Park Springs & SE	Laurient	J B	head	28	farm, farming
08	07B	48	Park Springs & SE	Laurient	Inez (BALDWIN)	wife	26	
08	07B	49	Park Springs & SE	Henderson	Grady	head	29	farm, farming
08	07B	50	Park Springs & SE	Henderson	Nancy (MUNNLEY/NUNNLEY)	wife	21	
08	07B	51	Park Springs & SE	Henderson	Billy	son	1	
08	07B	52	Park Springs & SE	Henderson	Samuel [Wayne]?	son	9/12	
08	07B	53	Park Springs & SE	Lynn	Griff	head	50	farm, farming
08	07B	54	Park Springs & SE	Lynn	Martha	wife	28	
08	07B	55	Park Springs & SE	Lynn	Charley	son	6	
08	07B	56	Park Springs & SE	Lynn	Dorothy	daughter	3	
08	07B	57	Park Springs & SE	Lynn	Grace	daughter	2	
08	07B	58	Park Springs & SE	Able	Forest	head	55	farm, farming
08	07B	59	Park Springs & SE	Tenley	Berk	head	45	farm, farming
08	07B	60	Park Springs & SE	Tenley	Bettie	wife	40	
08	07B	61	Park Springs & SE	Tenley	J W	son	19	
08	07B	62	Park Springs & SE	Tenley	Harold	son	18	
08	07B	63	Park Springs & SE	Tenley	Hurburt	son	17	
08	07B	64	Park Springs & SE	Tenley	Joesphine	daughter	16	
08	07B	65	Park Springs & SE	Tenley	Jaunita	daughter	14	
08	07B	66	Park Springs & SE	Tenley	Una mae	daughter	12	
08	07B	67	Park Springs & SE	Tenley	Charles	son	11	
08	07B	68	Park Springs & SE	Tenley	Walter	son	9	
08	07B	69	Park Springs & SE	Tenley	G H	son	7	
08	07B	70	Park Springs & SE	Tenley	Raymond	son	3	
08	07B	71	Park Springs & SE	Able	Will M [William Morgan]	head	73	farm, farming
08	07B	72	Park Springs & SE	Able	Betty [Bettie (MORRIS)]	wife	50	
08	07B	73	Park Springs & SE	Able	Boyce	daughter	24	
08	07B	74	Park Springs & SE	Able	Margrette [Marguerite Ruth]	daughter	21	
08	07B	75	Park Springs & SE	Able	Ozel [Virginia Ozelle]	daughter	17	
08	07B	76	Park Springs & SE	Dennison	Charles	head	70	farm, farming
08	07B	77	Park Springs & SE	Dennison	Norma	wife	57	
08	07B	78	Park Springs & SE	Dennison	Alice	daughter	20	
08	07B	79	Park Springs & SE	Adams	Robert L [Louis]	head	72	farming, farm
08	07B	80	Park Springs & SE	Adams	Mollie	wife	66	
08	08A	01	Park Springs & SE	Adams	Carl	son	24	new worker
08	08A	02	Park Springs & SE	Adams	Maggie	daughter	20	
08	08A	03	Park Springs & SE	Rodden	A N	head	53	farm, farming
08	08A	04	Park Springs & SE	Rodden	Vennie	wife	50	
08	08A	05	Park Springs & SE	Rodden	Duane	daughter	16	

**1940 ED 08 Park Springs and Area Southeast**

ED	Page	Line	Location	Last Name	First Name [(Additional Information)]	Relation	Age	Occupation
08	08A	06	Park Springs & SE	McClurg	F H	mo/law	70	
08	08A	07	Park Springs & SE	Callin	Cora	head	63	farm, farming
08	08A	08	Park Springs & SE	Rodden	Jess [Jessie on ML]	head	24	farm, farming
08	08A	09	Park Springs & SE	Rodden	Ora (FERNELL)	wife	24	
08	08A	10	Park Springs & SE	Nickols	William	head	80	farm, farming
08	08A	11	Park Springs & SE	Nickols	Bill	wife	70	
08	08A	12	Park Springs & SE	Shurbet	John	head	53	farm, farming
08	08A	13	Park Springs & SE	Shurbet	Anna	wife	50	
08	08A	14	Park Springs & SE	Shurbet	Elmer	son	23	new worker
08	08A	15	Park Springs & SE	Shurbet	Henry [H M]	head	41	farm, farming
08	08A	16	Park Springs & SE	Shurbet	Bert (WHEELER)	wife	38	
08	08A	17	Park Springs & SE	Shurbet	Glenn	son	13	
08	08A	18	Park Springs & SE	Shurbet	Hoyt [Hoyett Wheeler]	son	6	
08	08A	19	Park Springs & SE	Yearby	Lesly	head	35	farm, farming
08	08A	20	Park Springs & SE	Yearby	Georgia	wife	30	
08	08A	21	Park Springs & SE	Yearby	Anna	daughter	3	
08	08A	22	Park Springs & SE	Brown	D B [Daniel Burlin ]	head	32	farm, farming
08	08A	23	Park Springs & SE	Brown	Bertie Dean (LAWYER)]	wife	22	
08	08A	24	Park Springs & SE	Brown	Jeanette [Sue Jeanette]	daughter	4	
08	08A	25	Park Springs & SE	Lawyer	W C	fa/law	52	farm, farming
08	08A	26	Park Springs & SE	Lawyer	Della	mo/law	54	
08	08B	41	Park Springs & SE	Foresyth	Danie [Dewey Jefferson]	head	30	farm, farming
08	08B	42	Park Springs & SE	Foresyth	Viola (MOORE)	wife	28	
08	08B	43	Park Springs & SE	Foresyth	Marie	daughter	11	
08	08B	44	Park Springs & SE	Foresyth	Virginia [Nell]	daughter	8	
08	08B	45	Park Springs & SE	Foresyth	Delois [Jean]	daughter	3	
08	08B	46	Park Springs & SE	Smith	Albert	head	60	farm, farming
08	08B	47	Park Springs & SE	Smith	Martha	wife	57	
08	08B	48	Park Springs & SE	Smith	Henry	son	18	
08	08B	49	Park Springs & SE	Smith	John	son	16	
08	08B	50	Park Springs & SE	Ritchie	Albert	head	60	farm, farming
08	08B	51	Park Springs & SE	Ritchie	Mary	wife	58	
08	08B	52	Park Springs & SE	Hodge	W C [Wallace]	head	50	farm, farming
08	08B	53	Park Springs & SE	Hodge	Nettie [W]	wife	47	
08	08B	54	Park Springs & SE	Hodge	Margie [Ganell]	daughter	17	
08	08B	55	Park Springs & SE	Whitakar	I P [Ira Pascal]	head	76	farm, farming
08	08B	56	Park Springs & SE	White	John [Charles]	head	50	laborer, WPA
08	08B	57	Park Springs & SE	White	Elbert	son	28	
08	08B	58	Park Springs & SE	White	F M	son	18	
08	08B	59	Park Springs & SE	White	William	son	16	
08	08B	60	Park Springs & SE	Milton	Jack	head	50	laborer, WPA
08	08B	61	Park Springs & SE	Milton	Maryetta	daughter	20	
08	08B	62	Park Springs & SE	Milton	John	son	18	
08	08B	63	Park Springs & SE	Ball	Tom [Thomas J?]	head	56	laborer, WPA
08	08B	64	Park Springs & SE	Ball	Mary (PRICE)?	wife	54	
08	08B	65	Park Springs & SE	Ball	Coy	son	19	new worker, farming
08	08B	66	Park Springs & SE	Stone	Winford [Lee]	head	24	farm, farming
08	08B	67	Park Springs & SE	Stone	Edith (MORROW)	wife	22	
08	08B	68	Park Springs & SE	Champion	FA [Festus A]	head	55	farm, farming
08	08B	69	Park Springs & SE	Champion	Della L (WALLACE/WALLIS)]	wife	47	
08	08B	70	Park Springs & SE	Champion	John R	son	19	farm, farming
08	08B	71	Park Springs & SE	Champion	Wallace [Wallis Festus]	son	10	
08	08B	72	Park Springs & SE	Dickenson	Juanita [Katherine (CHAMPION)]	daughter	22	
08	08B	73	Park Springs & SE	Dickenson	Geo E [Edward]	gr/dau	0/12	

**1940 ED 08 Park Springs and Area Southeast**

ED	Page	Line	Location	Last Name	First Name [(Additional Information)]	Relation	Age	Occupation
08	09A	01	Park Springs & SE	<b>Johnson</b>	Emmett	head	38	farm, farmer
08	09A	02	Park Springs & SE	<b>Johnson</b>	Ella	wife	36	
08	09A	03	Park Springs & SE	<b>Cathery</b>	D R	head	37	farm, farmer
08	09A	04	Park Springs & SE	<b>Cathery</b>	Gertie	wife	36	
08	09A	05	Park Springs & SE	<b>Cathery</b>	Pauline	daughter	15	
08	09A	06	Park Springs & SE	<b>Cathery</b>	Joyce	daughter	10	
08	09A	07	Park Springs & SE	<b>Cathery</b>	Dell	daughter	7	
08	09A	08	Park Springs & SE	<b>Cathery</b>	Charles	son	5	
08	09A	09	Park Springs & SE	<b>Gamble</b>	Ray [James Ray]	head	35	farm
08	09A	10	Park Springs & SE	<b>Gamble</b>	Lillian [Erma (ARMSTRONG)]	wife	35	
08	09A	11	Park Springs & SE	<b>Gamble</b>	Ruby [Nell]	daughter	11	
08	09A	12	Park Springs & SE	<b>Gamble</b>	Glenn	son	10	
08	09A	13	Park Springs & SE	<b>Gamble</b>	Nancy [Lue]	daughter	7	
08	09A	14	Park Springs & SE	<b>Gamble</b>	Helen [Inez]	daughter	6/12	
08	09A	15	Park Springs & SE	<b>Western</b>	J T	head	24	farm
08	09A	16	Park Springs & SE	<b>Western</b>	Martha [Lee (LUMSDEN)]	wife	22	
08	09A	17	Park Springs & SE	<b>Maxwell</b>	N P	head	30	farm
08	09A	18	Park Springs & SE	<b>Maxwell</b>	Helen (McCLURG)	wife	24	
08	09A	19	Park Springs & SE	<b>Pond</b>	Henry	head	26	laborer
08	09A	20	Park Springs & SE	<b>Pond</b>	Edith	wife	20	
08	09A	21	Park Springs & SE	<b>Duck</b>	A D	head	30	laborer
08	09A	22	Park Springs & SE	<b>Duck</b>	Mary	wife	28	
08	09A	23	Park Springs & SE	<b>Duck</b>	Fannie	daughter	4	



# Index of Names for 1940 Wise County TX Census - ED 08 Park Springs and Area Southeast

(603 Names)

ED	Page	Line	Last Name	Given Name	ED	Page	Line	Last Name	Given Name	ED	Page	Line	Last Name	Given Name
08	07B	76	Dennison	Charles	08	01B	72	Harclerode	Maxine	08	03B	64	Huggins	Lou
08	07B	77	Dennison	Norma	08	01B	73	Harclerode	Norma Lou	08	03B	59	Huggins	Oral [Oscar]
08	08B	73	Dickenson	Geo E [Edward]	08	01B	75	Harclerode	Shelby	08	03B	61	Huggins	Oran W
08	08B	72	Dickenson	Juanita [Katherine (CHAMPION)]	08	01B	71	Harclerode	Vera [May]	08	03B	58	Huggins	Ruby
08	04B	56	Dobbs	Delois [Marie]	08	01B	70	Harclerode	William H	08	01B	54	Jackson	Annie [Jewel (McMILLAN)?]
08	01B	77	Dubby	Charlie R	08	01B	49	Harrison	Billy J [Joe]	08	01B	58	Jackson	Doyle
08	01B	78	Dubby	Eva	08	01A	28	Harrison	Calva [Merrion Calva (LYNCH)]	08	01B	55	Jackson	Eddie
08	01B	79	Dubby	Jack	08	01B	46	Harrison	J D	08	01B	56	Jackson	Grady
08	09A	21	Duck	A D	08	01B	47	Harrison	J W	08	01B	57	Jackson	Isay
08	09A	23	Duck	Fannie	08	01B	43	Harrison	Jesse	08	02B	78	Johnson	Binita
08	09A	22	Duck	Mary	08	01A	27	Harrison	Jewel [Jewell]	08	09A	02	Johnson	Ella
08	01A	21	Edge	Maggie	08	01B	44	Harrison	Julia O (WAYS)	08	09A	01	Johnson	Emmett
08	02A	15	Eubanks	C J	08	01B	48	Harrison	Louise	08	02B	80	Johnson	June [Ruby June]
08	02A	14	Eubanks	Arnal	08	01B	45	Harrison	Norman	08	02B	79	Johnson	Ladetta
08	02A	13	Eubanks	Laura	08	05B	72	Hayar	Lester	08	02B	77	Johnson	Mary
08	02A	16	Eubanks	Mary	08	07B	51	Henderson	Billy	08	02B	76	Johnson	Rupert [Orris]
08	02A	12	Eubanks	Tom D	08	07B	49	Henderson	Grady	08	01B	64	Keeler	David A
08	02A	38	Flowers	Joseph [Gentry]	08	07B	50	Henderson	Nancy (MUNNLEY/NU NNLEY)	08	01B	66	Keeler	David L
08	02A	39	Flowers	Myrtle [Odela (MEADOR)]	08	07B	52	Henderson	Samuel [Wayne]?]	08	01B	67	Keeler	Jack E
08	03B	73	Ford	Billy Ray	08	03A	31	Henton	Frankie [Edith Frances (MOWERY)]	08	01B	68	Keeler	Jesse E
08	03B	72	Ford	Frances [Ardella (ALEXANDER)]	08	03A	30	Henton	James W [Walter]	08	01B	65	Keeler	Luella
08	03B	75	Ford	J B	08	03A	32	Henton	Robert M	08	01B	69	Keeler	Warren D
08	03B	71	Ford	Jake	08	03A	33	Henton	Vernon R [Ray]	08	05A	18	Lancaster	Cecil [Wayne]
08	03B	74	Ford	Winford [Royce]	08	04B	59	Herren	Estogo	08	05A	17	Lancaster	Irene (MOORE)
08	08B	41	Foresyth	Danie [Dewey Jefferson]	08	04B	57	Herren	Joseph S	08	01A	31	Lasiter	Albert R
08	08B	45	Foresyth	Delois [Jean]	08	04B	58	Herren	Viola Fay	08	01A	34	Lasiter	Donald
08	08B	43	Foresyth	Marie	08	08B	54	Hodge	Margie [Ganell]	08	01A	33	Lasiter	Harold
08	08B	42	Foresyth	Viola (MOORE)	08	08B	53	Hodge	Nettie [W]	08	01A	32	Lasiter	Inez (JOHNSON)
08	08B	44	Foresyth	Virginia [Nell]	08	08B	52	Hodge	W C [Wallace]	08	03A	05	Lasiter	Ida [Rosa Ida (GORE)]
08	09A	12	Gamble	Glenn	08	01B	51	Hollingsworth	Faye	08	03A	04	Lasiter	Thomas [Granville/Granv el]
08	09A	14	Gamble	Helen [Inez]	08	01B	53	Hollingsworth	Frank M	08	07B	48	Laurient	Inez (BALDWIN)
08	09A	10	Gamble	Lillian [Erma (ARMSTRONG)]	08	01B	50	Hollingsworth	James P	08	07B	47	Laurient	J B
08	09A	13	Gamble	Nancy [Lue]	08	01B	52	Hollingsworth	Mary K	08	08A	26	Lawyer	Della
08	09A	09	Gamble	Ray [James Ray]	08	04A	26	Hollingsworth	Frank	08	08A	25	Lawyer	W C
08	09A	11	Gamble	Ruby [Nell]	08	07A	27	Houston	J W [James Walter]	08	07B	55	Lynn	Charley
08	01A	03	Gann	G Y	08	07A	30	Houston	Laren	08	07B	56	Lynn	Dorothy
08	01A	01	Gann	George Y [Yeaklet]	08	07A	28	Houston	Rachie [Rachel May (McDONALD)]	08	07B	57	Lynn	Grace
08	01A	02	Gann	Sarah (DRENNAN)	08	07A	29	Houston	Weldon	08	07B	53	Lynn	Griff
08	02B	51	Gann	Datus N [Needem]	08	07A	16	Huckabee	Doris [Elizabeth (POWERS)]	08	07B	54	Lynn	Martha
08	02B	53	Gann	Glenn G [Garvis]	08	07A	15	Huckabee	Edd H [Haines 'Chick']	08	07A	31	Manzingo	Alexander
08	05A	01	Gann	James C [Chester]	08	07A	18	Huckabee	Eddie E	08	07A	05	Mara	Bobby [Travis]
08	02B	54	Gann	Jennie [Lee]	08	06B	45	Huckabee	Evelyn	08	07A	06	Mara	Donellin [Doris Donella]
08	02B	52	Gann	Lora N [Nell (TOMPKINS)]	08	06B	43	Huckabee	James M [Monroe, Jr]	08	07A	03	Mara	John E [Edward]
08	05A	02	Gann	Susie E [Susan Elizabeth (COATES)]	08	07A	17	Huckabee	Joette	08	07A	04	Mara	Pearl (McGUIRE)
08	03B	65	Glass	Albert B [Brice, Sr.]	08	06B	46	Huckabee	Nolan	08	07A	07	Mara	Raymond [Bailey]
08	03B	67	Glass	Albert, Jr [Brice]	08	07A	19	Huckabee	Peggy Ann	08	07A	02	Marlette	Mireal
08	03B	66	Glass	Mabel [Dessie Mable (SAUNDERS)]	08	06B	44	Huckabee	Rebby (HAMILTON)	08	07A	01	Marlette	Truman
08	04A	19	Greeson	Charley W	08	03B	57	Huggins	Alice [Geneva Alice (BOYDSTON)]	08	05B	75	Martin	Edna
08	03A	18	Griffith	Geo W	08	03B	63	Huggins	Flora F	08	09A	18	Maxwell	Helen (McCLURG)
08	03A	19	Griffith	Nannie M	08	03B	56	Huggins	Henry W [Waterloo]	08	09A	17	Maxwell	N P
08	07A	32	Grulich	Adolph	08	03B	60	Huggins	Joyce	08	02A	18	May	Alfa
08	02B	70	Gumm	Billy L	08	03B	62	Huggins	Lorene	08	02A	17	May	Jack
08	02B	61	Hall	May	08	08A	06	McClurg	F H	08	08A	30	McDonald	Anna
08	04A	27	Hamilton	Jack F	08	03B	64	McGee	Bobby E	08	05B	64	McGee	Bobby E
08	01B	76	Harclerode	Jo	08	06B	69	McGee	Bonnie	08	06B	69	McGee	Bonnie
08	01B	74	Harclerode	Mary	08	06B	71	McGee	Clara [Mae (O'BRIEN)]	08	06B	71	McGee	Clara [Mae (O'BRIEN)]
										08	06B	70	McGee	Elbert L
										08	04A	21	McGee	Eloise



## Index of Names for 1940 Wise County TX Census - ED 08 Park Springs and Area Southeast

(603 Names)

ED	Page	Line	Last Name	Given Name	ED	Page	Line	Last Name	Given Name	ED	Page	Line	Last Name	Given Name
08	06B	67	McGee	Emily	08	07B	45	Murphy	Carol	08	05A	26	Robinson	Sarah (RICH)
08	05B	61	McGee	Francis M	08	07B	44	Murphy	Jean	08	08A	03	Rodden	A N
08	05B	63	McGee	Francis M	08	07B	43	Murphy	Margrette	08	08A	05	Rodden	Duane
08	06B	68	McGee	Ineza	08	07B	41	Murphy	William	08	08A	08	Rodden	Jess [Jessie on ML]
08	06B	66	McGee	Ira L	08	05B	74	Musgrove	Connie [Pearl (WHITE)]	08	08A	09	Rodden	Ora (FERNELL)
08	06B	72	McGee	Joy Lee [Lea]	08	05B	73	Musgrove	Sebe R [Seborn/Sebron Rosco]	08	08A	04	Rodden	Vennie
08	04A	01	McGee	Juanita	08	08A	11	Nickols	Bill	08	01A	30	Ross	John R
08	04A	20	McGee	Lorena [Wella (SMITH)]	08	08A	10	Nickols	William	08	01A	29	Ross	Orma (EDGE)
08	05B	62	McGee	Ruth O (HARDEE)	08	01A	14	Odell	Emma (GREEN)	08	05B	76	Sands	Henritta
08	03B	80	McGee	Leather [Odell]	08	01A	13	Odell	James P [Pat]	08	05B	58	Scales	Iva [May (EVANS) ]
08	06B	48	McKay	Lee B [Boyce]	08	01A	15	Odell	Patsy [Ruth]	08	05B	57	Scales	Tom B [Tommie]
08	04B	41	McKay	Lula	08	01B	62	O'Shields	C J	08	05B	80	Sharp	Cora
08	06B	47	McKay	Mary [Elizabeth (BUCKNER)]	08	01B	63	O'Shields	Carl	08	03A	34	Sherrrod	Clint C [Clinton L]
08	01A	40	McKeever	Elmer W [William]	08	01B	61	O'Shields	M J	08	08A	13	Shurbet	Anna
08	01B	41	McKeever	Evelene O (BONER)	08	01B	60	O'Shields	May (WAKEMON)?	08	08A	16	Shurbet	Bert (WHEELER)
08	01B	42	McKeever	Raymond W [William]	08	07A	26	Phillips	Allie	08	08A	14	Shurbet	Elmer
08	04B	61	McKinney	Frank	08	07A	24	Phillips	Harim	08	08A	17	Shurbet	Glenn
08	04B	62	McKinney	Georgia	08	07A	25	Phillips	Lee	08	08A	15	Shurbet	Henry [H M]
08	07A	22	McLane	Edith	08	09A	20	Pond	Edith	08	08A	18	Shurbet	Hoyt [Hoyett Wheeler]
08	07A	21	McLane	Geo A	08	09A	19	Pond	Henry	08	08A	12	Shurbet	John
08	07A	23	McLane	James	08	01B	59	Poteet	Roy	08	01A	37	Smith	Daniel E
08	02A	26	Meek	Charles J [John Charles]	08	05A	31	Price	Elizebeth	08	01A	39	Smith	Daniel H
08	02B	68	Meek	Chatherine [Catherine Estella (ROSS)]	08	05A	30	Price	William E	08	01A	11	Smith	Geo W
08	02A	27	Meek	Emma (GUFFIN)	08	05B	56	Pyeatt	M C [Mary]	08	01A	12	Smith	Jane
08	02A	29	Meek	Erma	08	04B	66	Randall	Harvey B	08	01A	22	Smith	John P
08	02A	31	Meek	Grace	08	04B	69	Randall	Harvey W	08	01A	38	Smith	Katie
08	02A	30	Meek	Grady [Lamond]	08	04B	67	Randall	Minnie [S (SMITH)]	08	08B	46	Smith	Albert
08	02A	32	Meek	J C [John Charles, Jr?]	08	04B	70	Randall	Pauline J	08	05B	52	Smith	Artie
08	02B	67	Meek	John [N]	08	04B	68	Randall	Wilburn	08	06B	60	Smith	Guy
08	02A	33	Meek	Josie	08	03B	70	Raney	Joe B	08	08B	48	Smith	Henry
08	02A	28	Meek	Lela	08	03B	69	Raney	Molly [Mollie V]	08	08B	49	Smith	John
08	02B	69	Meek	Margrite [Margret Sue]	08	03B	68	Raney	Sam C	08	06B	59	Smith	Maggie
08	08B	60	Milton	Jack	08	02A	37	Redwine	Anita	08	08B	47	Smith	Martha
08	08B	62	Milton	John	08	02A	35	Redwine	Dora [Merle (PICKENS)]	08	06B	58	Smith	Milton H
08	08B	61	Milton	Maryetta	08	02A	36	Redwine	Dorothy [Dorothe Marie]	08	05B	50	Smith	Peallie
08	04B	55	Mitchum	Ella [Ellen Olivia (HURDT)]	08	02A	34	Redwine	James C [Coy]	08	05B	49	Smith	Thomas A
08	04B	54	Mitchum	Jack M [Jackson]	08	07A	33	Rhodes	Flossie	08	05B	51	Smith	Virgil
08	04A	18	Montgomery	Chatherine	08	07A	38	Richardson	Annis	08	03A	36	Stone	Barbarie
08	04A	17	Montgomery	Ellen	08	07A	37	Richardson	J I	08	08B	67	Stone	Edith (MORROW)
08	05A	13	Moore	Anna Sue [Annie]	08	05A	04	Richey	Albert	08	03A	35	Stone	Frankie
08	05A	08	Moore	Beatrice [O (WALKER)]	08	05A	05	Richey	Cleta [Bell (SETSER)]	08	03A	37	Stone	Orell
08	05A	14	Moore	Bobby Jo [Bobbie]	08	05A	06	Richey	Kenneth W [Wayne]	08	03A	38	Stone	Roy B
08	05A	10	Moore	Claude	08	04B	71	Ritchie	Adam	08	08B	66	Stone	Winford [Lee]
08	05A	07	Moore	Edward R	08	08B	50	Ritchie	Albert	08	01A	23	Stringer	Maggie D
08	04A	02	Moore	J D	08	04B	72	Ritchie	Clarence [Darrell]	08	03A	28	Tally	David P
08	05A	12	Moore	Kenneth R	08	04B	74	Ritchie	Cynthia Ann	08	03A	29	Tally	Francis
08	05A	09	Moore	Viola	08	08B	51	Ritchie	Mary	08	05B	59	Taylor	Frank E [Eugene]
08	05A	11	Moore	Willie Opal	08	04B	73	Ritchie	Ruby [Clara (COX)]	08	05B	60	Taylor	Rosie [Rosa Mary]
08	02B	66	Morrow	Glinn [Edward]	08	06B	61	Robinson	Dick [Richard]	08	07B	59	Tenley	Berk
08	02B	64	Morrow	Grady [William]	08	06B	64	Robinson	Doris Y	08	07B	60	Tenley	Bettie
08	02B	63	Morrow	Murtle [Myrtle Adelia (CANTWELL)]	08	05A	25	Robinson	Elmer	08	07B	67	Tenley	Charles
08	02B	65	Morrow	V L [Vester Luffin]	08	03A	03	Robinson	Fred F	08	07B	69	Tenley	G H
08	02B	62	Morrow	Vester S [Vester Scott]	08	03A	01	Robinson	Irwin L [Lamar]	08	07B	62	Tenley	Harold
08	07B	42	Murphy	Alice	08	06B	62	Robinson	Lillian (KILLOUGH)	08	07B	63	Tenley	Hurburt
08	07B	46	Murphy	Billy	08	03A	02	Robinson	Maude D [Hizzie Maude (GULLEY)]	08	07B	61	Tenley	J W
					08	05A	27	Robinson	Rich	08	07B	65	Tenley	Jaunita
					08	06B	63	Robinson	Richard K	08	07B	64	Tenley	Joesphine
					08	06B	65	Robinson	Robbie [Bobbie Jean]	08	07B	70	Tenley	Raymond
										08	07B	66	Tenley	Una mae
										08	07B	68	Tenley	Walter
										08	07A	35	Thomas	Cora (McMILLEN)
										08	07A	36	Thomas	Fern
										08	07A	34	Thomas	Ira E [Ike]
										08	04A	05	Thornhill	Hubert A
										08	04A	06	Thornhill	Sybil

