

Wise County Texas 1940 Census

Enumeration District 249-15

Newark & Area Around Boyd

(Justice Precinct #5)

864 names (102 are in the Town of Newark) on 26 pages

The 1940 enumerator was Silas L. Morris

Images of original handwritten pages are online at <http://www.wisecountytexas.info/census/1940.htm>

Transcriptions of select information by

Pat Lefors Dawson

Checked by Pat Lefors Dawson

(The information in brackets and parenthesis came from county records,
comparison with the 1930 census, or personal knowledge)

Part of the 1940 census map showing the Town of Newark

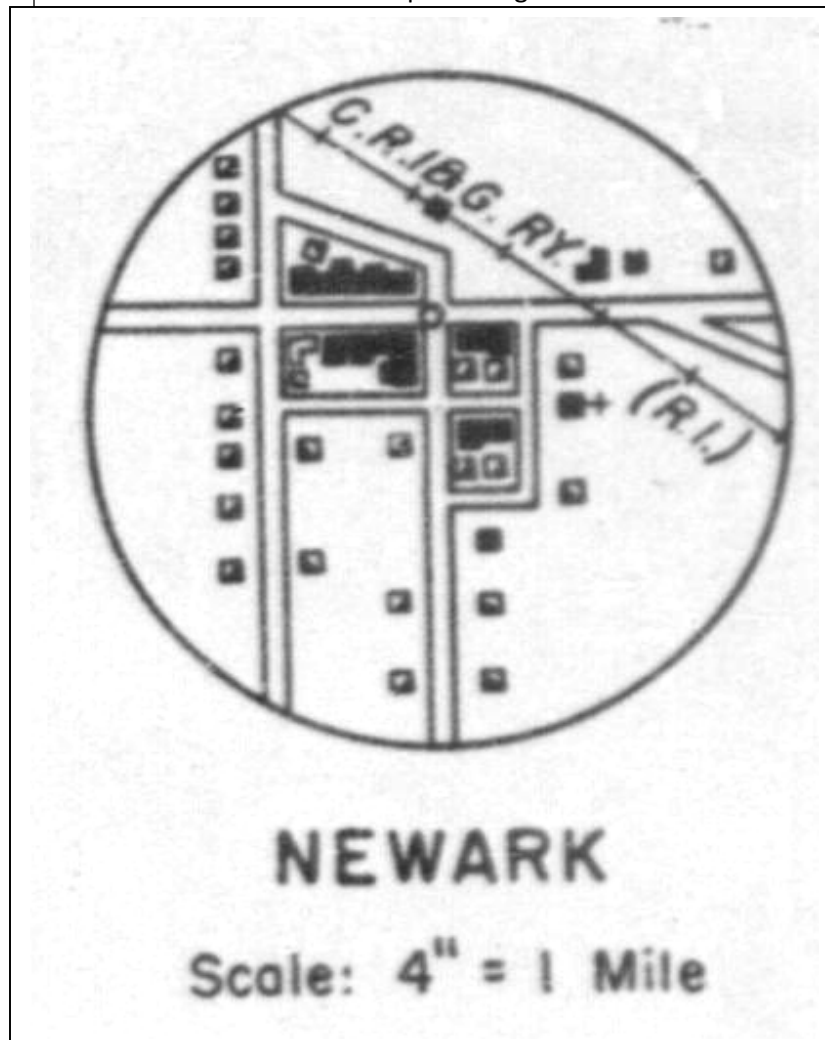

1940 census map showing ED 15 - North and South of Boyd

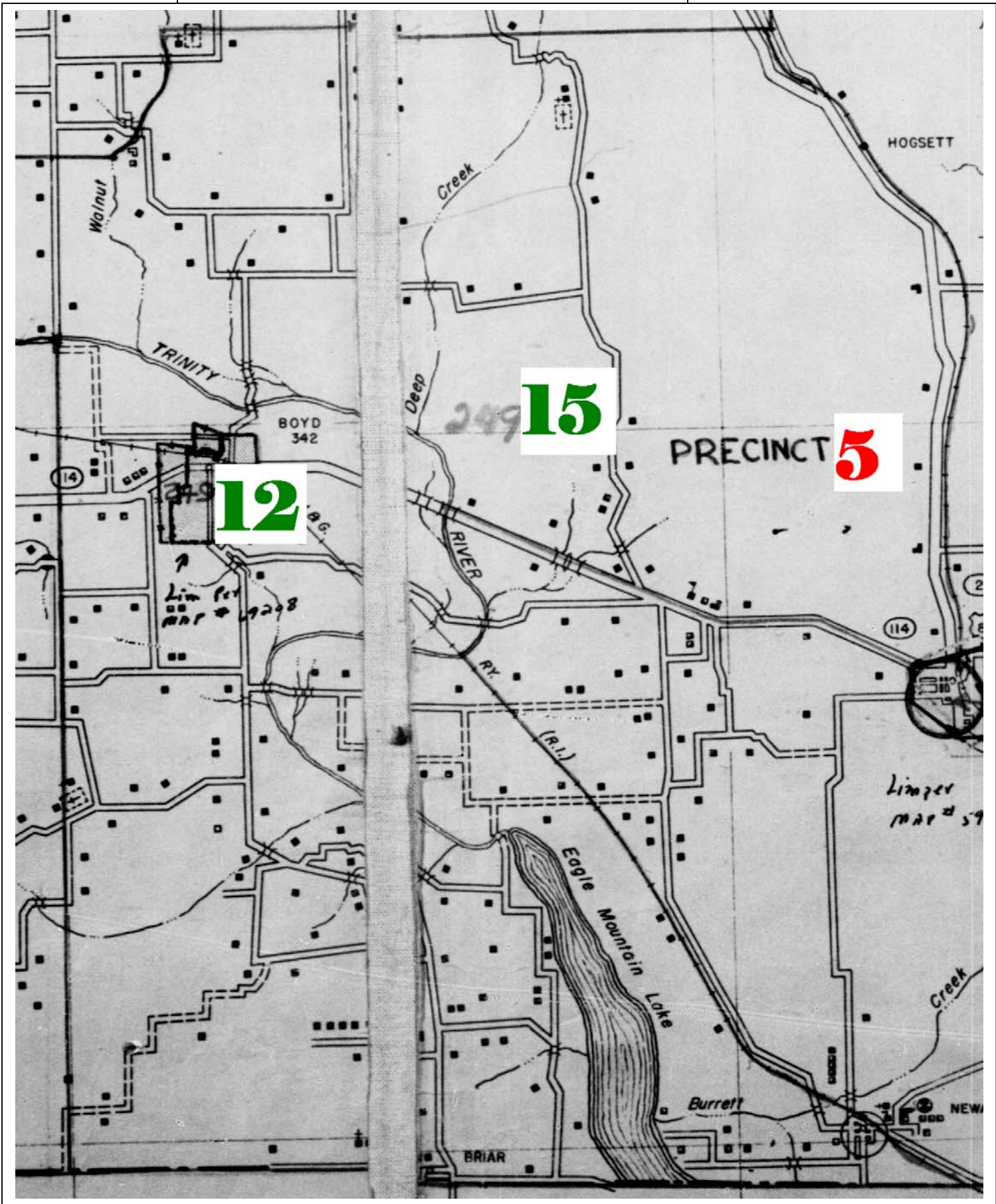

1940 ED 15 Newark Town and Boyd Area

ED	Page	Line	Location	Last Name	First Name (Additional Information)	Relation	Age	Occupation
15	01A	01	Rural Boyd Area	Norman	J. E. (James Ernest, Sr.)	Head	51	Farmer--Agriculture
15	01A	02	Rural Boyd Area	Norman	Letta (Letha Mae Lisby)	Wife	46	
15	01A	03	Rural Boyd Area	Norman	J. E. Jr. (James Ernest)	Son	22	Farmer
15	01A	04	Rural Boyd Area	Norman	Beryl (B. Anderson)	Son	18	Farmer
15	01A	05	Rural Boyd Area	Norman	Billy (B. Ray)	Son	10	
15	01A	06	Rural Boyd Area	Motley	V. C. (Vestal Carlton)	Head	40	Farmer--Agriculture & Cattle
15	01A	07	Rural Boyd Area	Motley	Exsa (Gordon)	Wife	37	
15	01A	08	Rural Boyd Area	Motley	Ervie (C.)	Son	17	
15	01A	09	Rural Boyd Area	Motley	Mozelle (Dorothy M.)	Daughter	10	
15	01A	10	Rural Boyd Area	Motley	Eugene (Olin Eugene)	Son	8	
15	01A	11	Rural Boyd Area	Eaton	Virgil R.	Head	37	Farmer--Agriculture & Cattle
15	01A	12	Rural Boyd Area	Eaton	Maurine	Wife	32	
15	01A	13	Rural Boyd Area	Eaton	Roy	Son	2	
15	01A	14	Rural Boyd Area	Caldwell	Nova (Belle Bowman)	Head	46	Farm Manager
15	01A	15	Rural Boyd Area	Caldwell	Warren G (W. G. Harding)	Son	19	Laborer, CCC Terracing Group
15	01A	16	Rural Boyd Area	Caldwell	Joe (Ferguson)	Son	15	
15	01A	17	Rural Boyd Area	Caldwell	Foy Sue	Daughter	12	
15	01A	18	Rural Boyd Area	Caldwell	Joyce (Bessie Joyce)	Daughter	4	
15	01A	19	Rural Boyd Area	Caldwell	Homer J. (Jay)	Son	21	Section Hand--Railroad
15	01A	20	Rural Boyd Area	Caldwell	Burnie Lee (Mason)	Daughter (In-law)	20	Waitress--Café
15	01A	21	Rural Boyd Area	Tribble	J. H. (Johnnie Haywood)	Head	45	Filling Station Operator--Gasoline
15	01A	22	Rural Boyd Area	Lee	Max	Hired Hand	19	Attendant--Gasoline Service Station
15	01A	23	Rural Boyd Area	Seals	C. W. (Colonel)	Head	36	Farmer--Cattle & Agriculture
15	01A	24	Rural Boyd Area	Seals	Lois (M. Tribble)	Wife	23	
15	01A	25	Rural Boyd Area	Seals	Jettielee	Daughter	7	
15	01A	26	Rural Boyd Area	Seals	Joyce	Daughter	4	
15	01A	27	Rural Boyd Area	Tribble	Finley R.	Father-in-law	57	Farmer--Cattle & Agriculture
15	01A	28	Rural Boyd Area	Tribble	Georgia	Mother-in-law	54	
15	01A	29	Rural Boyd Area	Jones	Cecil	Head	30	Farmer--Cattle & Agriculture
15	01A	30	Rural Boyd Area	Jones	Pearl	Wife	32	
15	01A	31	Rural Boyd Area	Simpson	Yovell	Head	38	Farmer--Cattle & Agriculture
15	01A	32	Rural Boyd Area	Simpson	Onell (A. O. Alexander)	Wife	20	
15	01A	33	Rural Boyd Area	Simpson	Virgie Lee (Virgale See)	Son	3	
15	01A	34	Rural Boyd Area	Simpson	Vernon	Son	1	
15	01A	35	Rural Boyd Area	Ross	Sam E.	Head	63	Farmer & Rancher--Cattle & Agriculture
15	01A	36	Rural Boyd Area	Ross	Florence	Wife	64	
15	01A	37	Rural Boyd Area	Carswell	William	Father-in-law	88	
15	01A	38	Rural Boyd Area	Fuller	Jack	Head	41	Farmer & Rancher--Cattle & Agriculture
15	01A	39	Rural Boyd Area	Fuller	Nell	Wife	30	
15	01A	40	Rural Boyd Area	Fuller	Betty Joe	Daughter	8	
15	01B	41	Rural Boyd Area	McGoodwin	Rube	Head	49	
15	01B	42	Rural Boyd Area	McGoodwin	Bele	Wife	37	
15	01B	43	Rural Boyd Area	Idell	Marvin (M. A.)	Head	28	Laborer, WPA BuildingEp
15	01B	44	Rural Boyd Area	Idell	Harold	Brother	15	
15	01B	45	Rural Boyd Area	Idell	Clyde	Brother	14	
15	01B	46	Rural Boyd Area	Idell	Rosa	Mother	56	
15	01B	47	Rural Boyd Area	Harwell	J. E. (Edgar J.)	Head	37	Store & Filling Station Operator--Gasoline & groceries
15	01B	48	Rural Boyd Area	Harwell	Velma (L. Brown)	Wife	37	
15	01B	49	Rural Boyd Area	Harwell	Jerelene	Daughter	14	
15	01B	50	Rural Boyd Area	Harwell	Morris (Eugene)	Son	10	
15	01B	51	Rural Boyd Area	Harwell	Epsie	Sister	32	
15	01B	52	Rural Boyd Area	Harwell	Myrtis ?	Sister	26	

1940 ED 15 Newark Town and Boyd Area

ED	Page	Line	Location	Last Name	First Name (Additional Information)	Relation	Age	Occupation
15	01B	53	Rural Boyd Area	Brown	J. A.	Father-in-law	69	
15	01B	54	Rural Boyd Area	Brown	T. G. (Thomas)	Head	55	Farmer--Agriculture
15	01B	55	Rural Boyd Area	Brown	Ella (H.)	Wife	54	
15	01B	56	Rural Boyd Area	Brown	Mildred (F.)	Daughter	27	Clerk--Variety Store
15	01B	57	Rural Boyd Area	Brown	Alberta	Daughter	21	
15	01B	58	Rural Boyd Area	McClary	Richard	Head	63	Laborer--WPA Construction
15	01B	59	Rural Boyd Area	McClary	Irma	Wife	43	
15	01B	60	Rural Boyd Area	McClary	Thomas	Son	20	Laborer--NVA Road Improvement
15	01B	61	Rural Boyd Area	Shimfr	T. L. (Taft Lafayette)	Head	31	Teacher--Ministerial
15	01B	62	Rural Boyd Area	Shimfr	Cassie (Castine Ella Brown)	Wife	30	
15	01B	63	Rural Boyd Area	Shimfr	Louella (Caslene Luella)	Daughter	8	
15	01B	64	Rural Boyd Area	Shimfr	Catherine (Cathrine Alberta)	Daughter	4	
15	01B	65	Rural Boyd Area	Brammer	M. C.	Head	49	Farmer--Agriculture
15	01B	66	Rural Boyd Area	Brammer	Lillie	Wife	44	
15	01B	67	Rural Boyd Area	Brammer	Viola Mae	Daughter	17	
15	01B	68	Rural Boyd Area	Brammer	Velma	Daughter	15	
15	01B	69	Rural Boyd Area	Brammer	Zelma	Daughter	15	
15	01B	70	Rural Boyd Area	Mosley	T. P. (Tom)	Head	65	Farmer--Agriculture
15	01B	71	Rural Boyd Area	Mosley	Pearl	Wife	60	
15	01B	72	Rural Boyd Area	Mosley	Ralph	Son	26	Farmer--Agriculture
15	01B	73	Rural Boyd Area	Mosley	John	Son	23	Farmer--Agriculture
15	01B	74	Rural Boyd Area	Jennings	H. D. (Herbert Dodson)	Head	26	Section Hand--Railroad
15	01B	75	Rural Boyd Area	Jennings	Tommie Lee (Brown)	Wife	23	
15	01B	76	Rural Boyd Area	Jennings	Robert Glen	Son	2	
15	01B	77	Rural Boyd Area	Jennings	Herbert Wayne	Son	5/12	
15	01B	78	Rural Boyd Area	Leonard	W. C. (William)	Head	70	
15	01B	79	Rural Boyd Area	Leonard	Fannie	Wife	65	
15	01B	80	Rural Boyd Area	Neel	J. W. (James Waller, Sr.)	Head	33	Farmer--Agriculture
15	02A	01	Rural Boyd Area	Neel	Linnie Belle (Vess)	Wife	29	
15	02A	02	Rural Boyd Area	Neel	Julia Mae	Daughter	13	
15	02A	03	Rural Boyd Area	Neel	W. L. (Willis)	Son	11	
15	02A	04	Rural Boyd Area	Neel	Gladys (Lucile)	Daughter	9	
15	02A	05	Rural Boyd Area	Neel	Mary Sue	Daughter	7	
15	02A	06	Rural Boyd Area	Neel	Jimmie Jr. (James Waller)	Son	6	
15	02A	07	Rural Boyd Area	Land	W. R.	Head	48	Farmer, Agriculture
15	02A	08	Rural Boyd Area	Land	Margaret	Wife	30	
15	02A	09	Rural Boyd Area	Green	Lillard	Hired Hand	23	Farmer, Agriculture
15	02A	10	Rural Boyd Area	Green	Callie Mae	Wife, hired hand	20	
15	02A	11	Rural Boyd Area	Cathey	James	Head	52	Farmer, Agriculture
15	02A	12	Rural Boyd Area	Green	L. T.	Head	57	Farmer, Agriculture
15	02A	13	Rural Boyd Area	Green	Ella	Wife	54	
15	02A	14	Rural Boyd Area	Niesmith	Ira	Head	52	Farm manager, Agriculture
15	02A	15	Rural Boyd Area	Smith	Mollie	Half-sister	78	
15	02A	16	Rural Boyd Area	Stokes	John	Head	20	Farmer, Agriculture
15	02A	17	Rural Boyd Area	Stokes	Bernice	Wife	20	
15	02A	18	Rural Boyd Area	Stokes	Robert M	Son	0/12	
15	02A	19	Rural Boyd Area	Adams	J. P.	Head	56	Farmer, Agriculture
15	02A	20	Rural Boyd Area	Adams	Lena	Wife	49	
15	02A	21	Rural Boyd Area	Reeves	Lee (Sr.)	Head	32	Farmer, Agriculture
15	02A	22	Rural Boyd Area	Reeves	Johnnie Lee	Wife	34	
15	02A	23	Rural Boyd Area	Reeves	Virginia	Daughter	13	
15	02A	24	Rural Boyd Area	Reeves	Lee, Jr.	Son	5	

1940 ED 15 Newark Town and Boyd Area

ED	Page	Line	Location	Last Name	First Name (Additional Information)	Relation	Age	Occupation
15	02A	25	Rural Boyd Area	Rogers	L.A. (Lee Ambers)	Head	47	Farmer, Agriculture
15	02A	26	Rural Boyd Area	Rogers	Ethel (Isbell)	Wife	42	
15	02A	27	Rural Boyd Area	Rogers	Marjorie (Louise)	Daughter	15	
15	02A	28	Rural Boyd Area	Paschall	Vance (Albert Vance)	Head	47	Farmer, Agriculture
15	02A	29	Rural Boyd Area	Paschall	Mattie Lee (Almanroad)	Wife	37	
15	02A	30	Rural Boyd Area	Cobb	E. A. (Elmer)	Head	53	Farmer, Agriculture
15	02A	31	Rural Boyd Area	Cobb	Maudie Lee	Wife	54	
15	02A	32	Rural Boyd Area	Cobb	John A.	Son	13	
15	02A	33	Rural Boyd Area	Jennings	T. O. (Tommie)	Head	56	Farmer, Agriculture
15	02A	34	Rural Boyd Area	Jennings	Naomi (N.)	Wife	48	
15	02A	35	Rural Boyd Area	Jennings	Bernie	Son	28	Farmer, Agriculture
15	02A	36	Rural Boyd Area	Jennings	Mattieleon (Mattie Leon Sims)	Daughter-in-law	25	
15	02A	37	Rural Boyd Area	Jennings	June (Deloris June)	Granddaughter	4/12	
15	02A	38	Rural Boyd Area	Cobb	George	Head	32	Laborer, WPA Construction Project
15	02A	39	Rural Boyd Area	Cobb	Nettie Belle (Swafford)	Wife	31	
15	02A	40	Rural Boyd Area	Cobb	Robert Cecil	Son	12	
15	02B	41	Rural Boyd Area	Cobb	Marion Lee Dale	Daughter	10	
15	02B	42	Rural Boyd Area	Cobb	Roger Albert	Son	4	
15	02B	43	Rural Boyd Area	Ernest	Berl	Head	30	Farmer, Agriculture
15	02B	44	Rural Boyd Area	Ernest	Opal	Wife	27	
15	02B	45	Rural Boyd Area	Ernest	Evail	Step-daughter	9	
15	02B	46	Rural Boyd Area	Ernest	James Earl	Son	5	
15	02B	47	Rural Boyd Area	Ernest	Thomas Wayne	Son	1	
15	02B	48	Rural Boyd Area	Ernest	Earl	Brother	25	Farmer, Agriculture
15	02B	49	Rural Boyd Area	Jeffery	J. T. (James)	Head	44	Laborer, WPA building project
15	02B	50	Rural Boyd Area	Jeffery	Roberta (Day)	Wife	50	
15	02B	51	Rural Boyd Area	Jeffery	Nettie Marie	Daughter	17	
15	02B	52	Rural Boyd Area	Jeffery	Charles (Evin)	Son	10	
15	02B	53	Rural Boyd Area	Walker	R. L.	Head	65	Farmer, Agriculture
15	02B	54	Rural Boyd Area	Walker	Maggie Louise (Castles)	Wife	61	
15	02B	55	Rural Boyd Area	Walker	Warner	Son	40	Mechanic
15	02B	56	Rural Boyd Area	Walker	Clarence	Son	27	Farmer, Agriculture
15	02B	57	Rural Boyd Area	Walker	Clyde	Son	23	Farmer, Agriculture
15	02B	58	Rural Boyd Area	Kidd	J. W. (James William)	Head	78	Farmer, Agriculture
15	02B	59	Rural Boyd Area	Kidd	Mary Catherine	Wife	77	
15	02B	60	Rural Boyd Area	Swafford	L. B.	Head	45	Farmer, Agriculture
15	02B	61	Rural Boyd Area	Swafford	Mary	Wife	43	
15	02B	62	Rural Boyd Area	Zortman	W. B.	Head	42	Farmer, Cattle & Agriculture
15	02B	63	Rural Boyd Area	Zortman	Ada Belle	Wife	39	Stenographer, Gas & oil
15	02B	64	Rural Boyd Area	Bray	Anna Bell	Hired Help	31	Housekeeper
15	02B	65	Rural Boyd Area	Bray	Henry Lee	Hired Helps Son	14	
15	02B	66	Rural Boyd Area	McBroom	W. M.	Head	43	Laborer, General work
15	02B	67	Rural Boyd Area	McBroom	Velma	Wife	37	
15	02B	68	Rural Boyd Area	McBroom	William	Son	19	Laborer, General work
15	02B	69	Rural Boyd Area	McBroom	Jack	Son	16	Laborer, General work
15	02B	70	Rural Boyd Area	McBroom	Helen	Daughter	14	
15	02B	71	Rural Boyd Area	McBroom	Henrietta	Daughter	9	
15	02B	72	Rural Boyd Area	McBroom	Billy Joe	Son	7	
15	02B	73	Rural Boyd Area	Young	Carlton	Head	24	Farmer, Agriculture
15	02B	74	Rural Boyd Area	Young	Loretta	Wife	22	
15	02B	75	Rural Boyd Area	Young	Sue	Daughter	5	
15	02B	76	Rural Boyd Area	Tedrow	E. C.	Head	23	Laborer, General work

1940 ED 15 Newark Town and Boyd Area

ED	Page	Line	Location	Last Name	First Name (Additional Information)	Relation	Age	Occupation
15	02B	77	Rural Boyd Area	Tedrow	Cora Bell	Wife	18	
15	02B	78	Rural Boyd Area	Sanders	Reed	Head	58	Farmer, Agriculture
15	02B	79	Rural Boyd Area	Sanders	Della	Wife	52	
15	02B	80	Rural Boyd Area	Sanders	J. A.	Son	17	
15	03A	01	Rural Boyd Area	Hague	C. I. (Columbus Iley)	Head	65	Farmer, Agriculture
15	03A	02	Rural Boyd Area	Hague	Lizzie	Wife	59	
15	03A	03	Rural Boyd Area	Hague	Juanita	Granddaughter	15	
15	03A	04	Rural Boyd Area	Hague	Doris	Granddaughter	14	
15	03A	07	Rural Boyd Area	Baker	Alvin	Head	41	Stock-farmer, Cattle & trader
15	03A	08	Rural Boyd Area	Baker	Evelyn	Wife	38	
15	03A	09	Rural Boyd Area	Baker	Billie Ray	Daughter	10	
15	03A	10	Rural Boyd Area	Cotton	H. L. (Henry)	Head	47	Laborer, WPA road project
15	03A	11	Rural Boyd Area	Cotton	Bernice	Wife	37	
15	03A	12	Rural Boyd Area	Cotton	Jack	Son	17	Farmer, Agriculture
15	03A	13	Rural Boyd Area	Cotton	Ray	Son	14	Farmer, Agriculture
15	03A	14	Rural Boyd Area	Cotton	John	Son	11	
15	03A	15	Rural Boyd Area	Cotton	Bobbie	Son	8	
15	03A	16	Rural Boyd Area	Cotton	Don (Lewis)	Son	5	
15	03A	17	Rural Boyd Area	Cotton	Faye	Daughter	19	
15	03A	18	Rural Boyd Area	Cotton	Freddie Faye	Granddaughter	1	
15	03A	19	Rural Boyd Area	Kemp	Joe (Joseph Edgar)	Head	28	Laborer, WPA construction project
15	03A	20	Rural Boyd Area	Kemp	Annie (Laure McCrary)	Wife	22	
15	03A	21	Rural Boyd Area	Kemp	Gilbert	Son	5	
15	03A	22	Rural Boyd Area	Kemp	Willis	Son	4	
15	03A	23	Rural Boyd Area	Kemp	Ruby Louise	Daughter	1	
15	03A	24	Rural Boyd Area	Young	C. E. (Charles)	Head	58	Farmer, Agriculture
15	03A	25	Rural Boyd Area	Young	Dora (J. McConnell)	Wife	56	
15	03A	26	Rural Boyd Area	Young	Emilie (Frances)	Daughter	19	
15	03A	27	Rural Boyd Area	Young	J. E. (John)	Son	16	
15	03A	28	Rural Boyd Area	Young	Joyce (G.)	Daughter	14	
15	03A	29	Rural Boyd Area	Sandlin	W. D.	Head	58	Conductor & Farmer, Railroad & Agriculture
15	03A	30	Rural Boyd Area	Sandlin	Anna	Wife	46	
15	03A	31	Rural Boyd Area	Cook	Marvin (Chapel)	Head	54	Laborer, WPA road project
15	03A	32	Rural Boyd Area	Cook	Urvel (Adams)	Wife	31	
15	03A	33	Rural Boyd Area	Cook	Dorothy Mae	Daughter	13	
15	03A	34	Rural Boyd Area	Cook	Betty Joe	Daughter	10	
15	03A	35	Rural Boyd Area	Cook	Lota	Daughter	8	
15	03A	36	Rural Boyd Area	Cook	Ray	Son	6	
15	03A	37	Rural Boyd Area	Cook	Sam (Houston)	Son	1	
15	03A	38	Rural Boyd Area	Womack	L. C.	Head	44	Farmer, Agriculture
15	03A	39	Rural Boyd Area	Womack	Lela	Wife	44	
15	03A	40	Rural Boyd Area	Womack	Sarah Ruth	Daughter	19	
15	03B	41	Rural Boyd Area	Womack	James	Son	15	
15	03B	42	Rural Boyd Area	Womack	Fred	Son	11	
15	03B	43	Rural Boyd Area	Smith	L. L. (Lewis)	Head	72	
15	03B	44	Rural Boyd Area	Smith	Agnes (A.)	Wife	63	
15	03B	45	Rural Boyd Area	Swimey	G. W. (George)	Head	34	Farmer, Agriculture
15	03B	46	Rural Boyd Area	Swimey	Cleo (Smith)	Wife	32	
15	03B	47	Rural Boyd Area	Swimey	Lois	Daughter	12	
15	03B	48	Rural Boyd Area	Swimey	Clayton	Son	10	
15	03B	49	Rural Boyd Area	Arrington	D. A. (Drew Alvin)	Head	40	Farmer, Agriculture
15	03B	50	Rural Boyd Area	Arrington	Elva (Louise Walker)	Wife	35	

1940 ED 15 Newark Town and Boyd Area

ED	Page	Line	Location	Last Name	First Name (Additional Information)	Relation	Age	Occupation
15	03B	51	Rural Boyd Area	Arrington	Venita	Daughter	13	
15	03B	52	Rural Boyd Area	Arrington	Betty Gene (Jean)	Daughter	8	
15	03B	53	Rural Boyd Area	Tedrow	Vestle M.	Head	34	Farmer, Agriculture
15	03B	54	Rural Boyd Area	Tedrow	Ellen	Wife	29	
15	03B	55	Rural Boyd Area	Walker	J. W.	Head	45	Farmer, Agriculture
15	03B	56	Rural Boyd Area	Walker	Beckie (Elizabeth Hubbard)	Wife	47	
15	03B	57	Rural Boyd Area	Walker	Willie	Daughter	15	
15	03B	58	Rural Boyd Area	Pavillard	Albert O.	Head	50	Farmer, Agriculture
15	03B	59	Rural Boyd Area	Pavillard	L. J. (Louis "Doc")	Brother	55	Farmer, Agriculture
15	03B	60	Rural Boyd Area	Dickey	Marie	Housekeeper	50	Housekeeper, Private house
15	03B	61	Rural Boyd Area	Wise	Barney S. (Sherwood)	Head	59	Farmer, Agriculture
15	03B	62	Rural Boyd Area	Wise	Ruth (Glenice Ruth Reid)	Wife	48	
15	03B	63	Rural Boyd Area	Wise	William	Son	24	Time keeper, WPA road project
15	03B	64	Rural Boyd Area	Wise	Morris	Son	21	Laborer, Globes Laboratory
15	03B	65	Rural Boyd Area	Wise	Elmo (James Elmore)	Son	17	
15	03B	66	Rural Boyd Area	Wise	Frankie Ruth	Daughter	12	
15	03B	67	Rural Boyd Area	Wise	Goldrie (Golda Re)	Daughter	9	
15	03B	68	Rural Boyd Area	Reid	Albert	Brother-in-law	58	Farmer, Agriculture
15	03B	69	Rural Boyd Area	Wilkinson	John W. (Westley)	Head	50	Farmer, Agriculture
15	03B	70	Rural Boyd Area	Wilkinson	Edith	Wife	40	
15	03B	71	Rural Boyd Area	Wilkinson	Morey Ruth	Daughter	13	
15	03B	72	Rural Boyd Area	Wilkinson	Albert Lee	Son	11	
15	03B	73	Rural Boyd Area	Wilkinson	Johnnie Mae	Daughter	7	
15	03B	74	Rural Boyd Area	Wilkinson	Ruby June	Daughter	4	
15	03B	75	Rural Boyd Area	Wright	Jefferson (W.)	Head	75	
15	03B	76	Rural Boyd Area	Wright	Martha (E.)	Wife	65	
15	03B	77	Rural Boyd Area	Wright	Luther (E.)	Son	33	Laborer, WPA road project
15	03B	78	Rural Boyd Area	Wright	Bertha Mae	Daughter	25	
15	03B	79	Rural Boyd Area	Wright	W. A.	Son	23	
15	03B	80	Rural Boyd Area	Sullivan	E. V. (Eugene Victor)	Head	28	Laborer, WPA road project
15	04A	01	Rural Boyd Area	Sullivan	Gladys	Wife	27	
15	04A	02	Rural Boyd Area	Sullivan	Onita	Daughter	7	
15	04A	03	Rural Boyd Area	Sullivan	Anna Joe	Daughter	5	
15	04A	04	Rural Boyd Area	Sullivan	Billy Gene	Son	3	
15	04A	05	Rural Boyd Area	Sullivan	Betty Sue	Daughter	2	
15	04A	06	Rural Boyd Area	Sullivan	Lola Mae	Daughter	0/12	
15	04A	07	Rural Boyd Area	Oates	Paul (M. 'Red')	Head	26	Farmer, Agriculture
15	04A	08	Rural Boyd Area	Oates	Leona (Elizabeth Taylor)	Wife	25	
15	04A	09	Rural Boyd Area	Oates	Mable Lee	Daughter	1	
15	04A	10	Rural Boyd Area	Womack	J. E.	Head	34	Farmer, Agriculture
15	04A	11	Rural Boyd Area	Womack	Jewel	Wife	31	
15	04A	12	Rural Boyd Area	Walker	Garland	Head	46	Farmer, Agriculture
15	04A	13	Rural Boyd Area	Walker	Eugene	Son	19	Farmer, Agriculture
15	04A	14	Rural Boyd Area	Walker	Mildred	Daughter-in-law	19	
15	04A	15	Rural Boyd Area	Walker	Betty Gene (Jean)	granddaughter	6/12	
15	04A	16	Rural Boyd Area	Smith	John (Posie Everett, Sr.)	Head	28	Farmer, Agriculture
15	04A	17	Rural Boyd Area	Smith	Lula Mae (Voiett)	Wife	27	
15	04A	18	Rural Boyd Area	Smith	John Bob	Son	5	
15	04A	19	Rural Boyd Area	Smith	Billy	Son	9/12	
15	04A	20	Rural Boyd Area	Taylor	James F. (Frank)	Head	46	Laborer, WPA Road Project
15	04A	21	Rural Boyd Area	Taylor	Pauline	Wife	30	
15	04A	22	Rural Boyd Area	Taylor	Frankie (Frankalin)	Daughter	14	

1940 ED 15 Newark Town and Boyd Area

ED	Page	Line	Location	Last Name	First Name (Additional Information)	Relation	Age	Occupation
15	04A	23	Rural Boyd Area	Taylor	James	Son	12	
15	04A	24	Rural Boyd Area	Patterson	B. F.	Head	34	Section hand, Railroad
15	04A	25	Rural Boyd Area	Patterson	Stella	Wife	27	
15	04A	26	Rural Boyd Area	Patterson	Gloria June	Daughter	7	
15	04A	27	Rural Boyd Area	Patterson	Elbert	Son	6	
15	04A	28	Rural Boyd Area	Patterson	Stella Mae	Daughter	4	
15	04A	29	Rural Boyd Area	Moreland	R. W. (Robert, Sr.)	Head	50	Farmer, Agriculture
15	04A	30	Rural Boyd Area	Moreland	Lyddia	Wife	42	
15	04A	31	Rural Boyd Area	Moreland	Lizzie Belle	Daughter	18	
15	04A	32	Rural Boyd Area	Moreland	Robert Jr. (W.)	Son	16	Farmer, Agriculture
15	04A	33	Rural Boyd Area	Moreland	Ozelle	Daughter	14	
15	04A	34	Rural Boyd Area	Moreland	Jimmie	Son	11	
15	04A	35	Rural Boyd Area	Moreland	Billy Marvin	Son	9	
15	04A	36	Rural Boyd Area	Moreland	Margie Jane	Daughter	6	
15	04A	37	Rural Boyd Area	Ford	M. M. (Marion Manley, Sr.)	Head	61	Farmer, Agriculture
15	04A	38	Rural Boyd Area	Ford	Roberta	Wife	56	
15	04A	39	Rural Boyd Area	Ford	Lynndia	Daughter	20	
15	04A	40	Rural Boyd Area	Ford	Belfa	Daughter	18	
15	04B	41	Rural Boyd Area	Ford	M.M. (Marion Manely Jr.)	Son	15	Farmer, Agriculture
15	04B	42	Rural Boyd Area	Yoakum	L. M. (Lonnie)	Head	58	Farmer, Agriculture
15	04B	43	Rural Boyd Area	Yoakum	Emma Mabel	Wife	59	
15	04B	44	Rural Boyd Area	Looper	Orville	Head	29	Farmer, Agriculture
15	04B	45	Rural Boyd Area	Looper	Irene	Wife	17	
15	04B	46	Rural Boyd Area	McCrary	R. E. (Robert Edgar)	Head	57	Laborer, WPA Building Project
15	04B	47	Rural Boyd Area	McCrary	Carrie (Olivia Cagle)	Wife	51	
15	04B	48	Rural Boyd Area	McCrary	Louise	Daughter	16	
15	04B	49	Rural Boyd Area	McCrary	Watson	Son	14	
15	04B	50	Rural Boyd Area	McCrary	Homer (James)	Son	11	
15	04B	51	Rural Boyd Area	Courtney	H. M. (Harry)	Head	49	Consturction, Building
15	04B	52	Rural Boyd Area	Courtney	Selma	Wife	36	
15	04B	53	Rural Boyd Area	Pope	J.	Head	58	Farmer, Agriculture
15	04B	54	Rural Boyd Area	Pope	Edith	Wife	58	
15	04B	55	Rural Boyd Area	Pope	John	Son	18	
15	04B	56	Rural Boyd Area	Pope	Dorothy Mae	Daughter	15	
15	04B	57	Rural Boyd Area	Pegues	George (William)	Head	52	Farmer, Agriculture
15	04B	58	Rural Boyd Area	Pegues	Etta (May Bearden)	Wife	46	Poet, Home
15	04B	59	Rural Boyd Area	Pegues	C. Hugh (Hugh C.)	Son	19	Laborer, Father's farm
15	04B	60	Rural Boyd Area	Pegues	June	Daughter	17	Laborer, Father's farm
15	04B	61	Rural Boyd Area	Pegues	Theodore	Son	15	Laborer, Father's farm
15	04B	62	Rural Boyd Area	Bearden	Theodore	Brother-in-law	52	
15	04B	63	Rural Boyd Area	Drain	Archie (Lee)	Head	29	Farmer, Agriculture
15	04B	64	Rural Boyd Area	Drain	Johnnie (Leonard McCrary)	Wife	26	
15	04B	65	Rural Boyd Area	Drain	Lucille (Jewell Lucile)	Daughter	4	
15	04B	66	Rural Boyd Area	Drain	Thomas Atkins	Son	2	
15	04B	67	Rural Boyd Area	McCraw	T. O. (Thomas Owens)	Head	50	Farmer, Agriculture
15	04B	68	Rural Boyd Area	McCraw	Georgia (Clementine Rexroat)	Wife	41	
15	04B	69	Rural Boyd Area	McCraw	Robert	Son	6	
15	04B	70	Rural Boyd Area	McCraw	Rosa Myrtle (Rosie Nall)	Daughter	4	
15	04B	71	Rural Boyd Area	Randolph	W. B. (William Blake)	Head	56	Farmer, Agriculture
15	04B	72	Rural Boyd Area	Randolph	Annie (Brown)	Wife	55	
15	04B	73	Rural Boyd Area	Randolph	Albert (Lee)	Son	22	Farmer, Agriculture
15	04B	74	Rural Boyd Area	Randolph	William (M.)	Son	19	

1940 ED 15 Newark Town and Boyd Area

ED	Page	Line	Location	Last Name	First Name (Additional Information)	Relation	Age	Occupation
15	04B	75	Rural Boyd Area	Randolph	Corrine	Daughter	17	
15	04B	76	Rural Boyd Area	Randolph	L. B.	Son	15	
15	04B	77	Rural Boyd Area	Splawn	G. E.	Head	40	Farmer, Agriculture
15	04B	78	Rural Boyd Area	Splawn	Mollie	Wife	43	
15	04B	79	Rural Boyd Area	Splawn	Imogene	Daughter	21	
15	04B	80	Rural Boyd Area	Hunn	Tony R. (Toney Robert)	Head	46	Farmer, Agriculture
15	05A	01	Rural Boyd Area	Hunn	Reba (Moses)	Wife	37	
15	05A	02	Rural Boyd Area	Hunn	Jack	Son	14	
15	05A	03	Rural Boyd Area	Hunn	Terry	Son	10	
15	05A	04	Rural Boyd Area	Hunn	Van (T.)	Son	7	
15	05A	05	Rural Boyd Area	Hunn	Russel	Son	5	
15	05A	06	Rural Boyd Area	Hunn	Mary Ann	Daughter	1	
15	05A	07	Rural Boyd Area	Able	Frank (Thomas Franklin)	Head	70	Farmer, Cattle & Agriculture
15	05A	08	Rural Boyd Area	Smith	D. M. (David Milford)	Head	41	Farmer, Agriculture
15	05A	09	Rural Boyd Area	Smith	Letha Margret (Margaret)	Wife	36	
15	05A	10	Rural Boyd Area	Smith	Vela Viola	Daughter	16	
15	05A	11	Rural Boyd Area	Smith	Ruby Faye	Daughter	14	
15	05A	12	Rural Boyd Area	Smith	Ester Bell	Daughter	7	
15	05A	13	Rural Boyd Area	Smith	Lizzie	Daughter	6	
15	05A	14	Rural Boyd Area	Smith	Eva Mae	Daughter	5	
15	05A	15	Rural Boyd Area	Smith	Margret (Margaret)	Daughter	1	
15	05A	16	Rural Boyd Area	Smith	J. Frank	Head	50	Farmer, Agriculture
15	05A	17	Rural Boyd Area	Smith	Nettie	Wife	48	
15	05A	18	Rural Boyd Area	Smith	Wayne	Son	25	Farmer, Agriculture
15	05A	19	Rural Boyd Area	Smith	Estelline	Daughter	17	
15	05A	20	Rural Boyd Area	Smith	Vonna Rey	Daughter	13	
15	05A	21	Rural Boyd Area	Trussell	G. W. (George)	Head	66	Farmer, Agriculture
15	05A	22	Rural Boyd Area	Trussell	Lizzie (Omega Soloman)	Wife	54	
15	05A	23	Rural Boyd Area	Trussell	Ruby George	Daughter	29	Teacher, Boyd High School
15	05A	24	Rural Boyd Area	Trussell	Wynelle (Gladys)	Daughter	16	
15	05A	25	Rural Boyd Area	Flowers	E. D. (Earnest)	Head	39	Farmer, Agriculture
15	05A	26	Rural Boyd Area	Flowers	Bertha (E. Jameson)	Wife	40	
15	05A	28	Rural Boyd Area	Flowers	Laverne	Son	17	
15	05A	29	Rural Boyd Area	Flowers	Harvey Earl (Eugene)	Son	12	
15	05A	30	Rural Boyd Area	Butler	W. C. (William Cletus)	Head	39	Farmer, Agriculture
15	05A	31	Rural Boyd Area	Butler	Dorothy (V. Jackson)	Daughter	16	
15	05A	32	Rural Boyd Area	Butler	Lola (D.)	Daughter	12	
15	05A	33	Rural Boyd Area	North	W. L. (William Lee)	Head	46	Farmer, Agriculture
15	05A	34	Rural Boyd Area	North	Grace (M.)	Wife	42	
15	05A	35	Rural Boyd Area	North	Mary Lee	Daughter	16	
15	05A	36	Rural Boyd Area	Lockhart	D. W. (Daniel Ward, Sr.)	Head	52	Laborer, Soil Erosion
15	05A	37	Rural Boyd Area	Lockhart	Laura (Jane Harkins)	Wife	46	
15	05A	38	Rural Boyd Area	Lockhart	Barney	Son	18	
15	05A	39	Rural Boyd Area	Lockhart	Garland	Son	16	
15	05A	40	Rural Boyd Area	Lockhart	Frankie	Daughter	14	
15	05B	41	Rural Boyd Area	Lockhart	Ruth (Naomi Ruth)	Daughter	13	
15	05B	42	Rural Boyd Area	Lockhart	Ruby Jo	Daughter	11	
15	05B	43	Rural Boyd Area	Lockhart	Ward Jr. (Daniel Ward)	Son	8	
15	05B	44	Rural Boyd Area	Lockhart	Margie	Daughter	5	
15	05B	45	Rural Boyd Area	Lockhart	Troy Lloyd	Son	2	
15	05B	46	Rural Boyd Area	Burnett	Henry R. (Pickney)	Head	30	Farmer, Agriculture
15	05B	47	Rural Boyd Area	Burnett	Etta Marie (Howe)	Wife	26	

1940 ED 15 Newark Town and Boyd Area

ED	Page	Line	Location	Last Name	First Name (Additional Information)	Relation	Age	Occupation
15	05B	48	Rural Boyd Area	Stantzenberger	Garvis	Stepson	5	
15	05B	49	Rural Boyd Area	Stantzenberger	Aubrey K.	Stepson	3	
15	05B	50	Rural Boyd Area	Burnett	Douglas Henry	Son	8/12	
15	05B	51	Rural Boyd Area	Read	Wayne (Norbert)	Head	29	Farmer, Agriculture
15	05B	52	Rural Boyd Area	Read	Bertha Lee (Darwin)	Wife	30	
15	05B	53	Rural Boyd Area	Read	Barbara Ann	Daughter	5	
15	05B	54	Rural Boyd Area	Read	Elaine (Doris Elaine)	Daughter	7/12	
15	05B	55	Rural Boyd Area	Heard	John D.	Head	60	Farmer, Agriculture
15	05B	56	Rural Boyd Area	Eubanks	Earnest (William, Sr.)	Son-in-law	40	Farmer, Agriculture
15	05B	57	Rural Boyd Area	Eubanks	Mattie (Leota Heard)	Daughter	35	
15	05B	58	Rural Boyd Area	Eubanks	Earnest Jr. (William)	Grandson	11	
15	05B	59	Rural Boyd Area	Eubanks	Mary (Katherine)	Granddaughter	8	
15	05B	60	Rural Boyd Area	Eubanks	Elmer Joe	Granddaughter	1	
15	05B	61	Rural Boyd Area	Burnett	Marce	Head	52	Farmer, Agriculture
15	05B	62	Rural Boyd Area	Burnett	Betty	Wife	47	
15	05B	63	Rural Boyd Area	Burnett	Victor	Son	16	
15	05B	64	Rural Boyd Area	Burnett	Betty Jo	Daughter	13	
15	05B	65	Rural Boyd Area	Burnett	Dortha Kay	Daughter	5	
15	05B	66	Rural Boyd Area	Harrison	C. J. (Clarence, Sr.)	Head	47	Farmer, Agriculture
15	05B	67	Rural Boyd Area	Harrison	Floy (Lindel Shearin)	Wife	42	
15	05B	68	Rural Boyd Area	Harrison	C. J. Jr. (Clarence)	Son	14	
15	05B	69	Rural Boyd Area	Ford	W. G. (William Grady)	Head	39	Laborer, WPA road project
15	05B	70	Rural Boyd Area	Ford	Imarie	Wife	27	
15	05B	71	Rural Boyd Area	Ford	John	Son	6	
15	05B	72	Rural Boyd Area	Ford	Bobbie Ray	Son	3	
15	05B	73	Rural Boyd Area	Freiley	J. A.	Head	47	
15	05B	74	Rural Boyd Area	Freiley	Anna Lou	Wife	43	
15	05B	75	Rural Boyd Area	Freiley	Shirley (L.)	Daughter	18	
15	05B	76	Rural Boyd Area	Freiley	June (Loui June)	Daughter	15	
15	05B	77	Rural Boyd Area	Freiley	Jack (Jeso H.)	Son	10	
15	05B	78	Rural Boyd Area	Freiley	Naida Rosa	Daughter	9	
15	05B	79	Rural Boyd Area	Peel	Willard	Head	23	Laborer, WPA road project
15	05B	80	Rural Boyd Area	Peel	Seina (Senna Highfill)	Wife	20	
15	06A	01	Rural Boyd Area	Peel	Martha Marie	Daughter	1	
15	06A	02	Rural Boyd Area	Ratliff	C. T. (Calvin)	Head	84	Farmer, Agriculture
15	06A	03	Rural Boyd Area	Ratliff	Paralee (F.)	Wife	80	
15	06A	04	Rural Boyd Area	Matthews	Z. D. (Zachariah)	Head	73	Farmer, Agriculture
15	06A	05	Rural Boyd Area	Matthews	Luna (O.Burrow)	Wife	64	
15	06A	06	Rural Boyd Area	Madewell	D. Y.	Head	41	Laborer, WPA Road Project
15	06A	07	Rural Boyd Area	Madewell	Winnie	Wife	34	
15	06A	08	Rural Boyd Area	Madewell	Ruth	Daughter	15	
15	06A	09	Rural Boyd Area	Madewell	Evelyn	Daughter	13	
15	06A	10	Rural Boyd Area	Madewell	J. D.	Son	11	
15	06A	11	Rural Boyd Area	Madewell	Aaron	Son	8	
15	06A	12	Rural Boyd Area	Brawley	W. R. (Wesley)	Head	39	Laborer, WPA Road Project
15	06A	13	Rural Boyd Area	Brawley	Rosa Lee	Wife	31	
15	06A	14	Rural Boyd Area	Brawley	Clarence	Son	13	
15	06A	15	Rural Boyd Area	Brawley	Hershel	Son	10	
15	06A	16	Rural Boyd Area	Brawley	Royce	Son	8	
15	06A	17	Rural Boyd Area	Brawley	Joyce	Daughter	8	
15	06A	18	Rural Boyd Area	Brawley	Boyd	Son	7	
15	06A	19	Rural Boyd Area	Brawley	Melba	Daughter	5	

1940 ED 15 Newark Town and Boyd Area

ED	Page	Line	Location	Last Name	First Name (Additional Information)	Relation	Age	Occupation
15	06A	20	Rural Boyd Area	Brawley	James Don	Son	3	
15	06A	21	Rural Boyd Area	Hamilton	T. W. (Thomas William)	Head	56	Farmer, Agriculture
15	06A	22	Rural Boyd Area	Hamilton	Mittie (Stone)	Wife	40	
15	06A	23	Rural Boyd Area	Bolles	Harley	Son	17	
15	06A	24	Rural Boyd Area	Bolles	Denver	Son	13	
15	06A	25	Rural Boyd Area	Stone	Gene (Jeanne)	Daughter	5	
15	06A	26	Rural Boyd Area	McKinney	W. J.	Head	64	Laborer, General work
15	06A	27	Rural Boyd Area	McKinney	Martha P	Wife	71	
15	06A	28	Rural Boyd Area	Young	Mary (Young)	Daughter	31	
15	06A	29	Rural Boyd Area	Young	Thomas	Grandson	11	
15	06A	30	Rural Boyd Area	Young	Jo Ann	Granddaughter	9	
15	06A	31	Rural Boyd Area	Tatum	Hass	Head	51	Farmer, Agriculture
15	06A	32	Rural Boyd Area	Tatum	Effie (Pearl Ratliff)	Wife	51	
15	06A	33	Rural Boyd Area	Tatum	O. T.	Son	22	
15	06A	34	Rural Boyd Area	Raspberry	J. R.	Hired hand	56	Farmer, Agriculture
15	06A	35	Rural Boyd Area	Ratliff	D. W. (Derrick)	Brother-in-law	49	Farmer, Agriculture
15	06A	36	Rural Boyd Area	Wilson	T. J. (Tollie James)	Head	52	Salesman, Automobile parts
15	06A	37	Rural Boyd Area	Wilson	Rhoda (Doritha Lefors)	Wife	47	
15	06A	38	Rural Boyd Area	Wilson	J. T. (James Tollie " JT")	Son	22	Attendant & mechanic, Filling station
15	06A	39	Rural Boyd Area	Wilson	Tommie June (Jones)	Daughter	16	
15	06A	40	Rural Boyd Area	Wilson	Charline (Charlene)	Niece	8	
15	06B	41	Rural Boyd Area	Thompson	Willie (Ada)	Head	57	
15	06B	42	Rural Boyd Area	Thompson	Warner (James)	Son	36	Farmer, Agriculture
15	06B	43	Rural Boyd Area	Thompson	Alvie	Son	35	Farmer, Agriculture
15	06B	44	Rural Boyd Area	Thompson	Aubrey	Son	25	Farmer, Agriculture
15	06B	45	Rural Boyd Area	Thompson	Hershel (Hershell)	Son	17	Farmer, Agriculture
15	06B	46	Rural Boyd Area	Thompson	Louise (D.)	Daughter	14	
15	06B	47	Rural Boyd Area	Thompson	J. D. (John David)	Son	23	Truck driver, CCC camp
15	06B	48	Rural Boyd Area	Phillips	W. G. (Will)	Head	62	Farmer, Agriculture
15	06B	49	Rural Boyd Area	Phillips	Notie (M.)	Wife	57	
15	06B	50	Rural Boyd Area	Smith	W. E. (William Edward)	Head	37	Farmer, Agriculture
15	06B	51	Rural Boyd Area	Smith	Georgia	Wife	28	
15	06B	52	Rural Boyd Area	Smith	Bernice	Daughter	8	
15	06B	53	Rural Boyd Area	Smith	Alice Pearl	Daughter	7	
15	06B	54	Rural Boyd Area	Smith	Opal Faye	Daughter	6	
15	06B	55	Rural Boyd Area	Smith	George Thomas	Son	1	
15	06B	56	Rural Boyd Area	Smith	E. J., Mrs.	Head	64	
15	06B	57	Rural Boyd Area	Smith	Dora	Daughter	40	
15	06B	58	Rural Boyd Area	Wright	J. A. (John)	Head	66	Farmer, Agriculture
15	06B	59	Rural Boyd Area	Wright	Tellie (E.)	Wife	65	
15	06B	60	Rural Boyd Area	Cole	A. J. (Andrew Jackson)	Head	57	Farmer, Agriculture
15	06B	61	Rural Boyd Area	Cole	Mytle	Wife	47	
15	06B	62	Rural Boyd Area	Austin	D. F.	Head	70	
15	06B	63	Rural Boyd Area	Austin	Mary E.	Wife	56	
15	06B	64	Rural Boyd Area	Austin	Errett	Son	20	Farmer, Agriculture
15	06B	65	Rural Boyd Area	Austin	Nellie	Daughter	14	
15	06B	66	Rural Boyd Area	Flowers	Darwin	Grandson	12	
15	06B	67	Rural Boyd Area	Pillow	Robert	Head	31	Farmer, Agriculture
15	06B	68	Rural Boyd Area	Pillow	Glady	Wife	33	
15	06B	69	Rural Boyd Area	Reynolds	Eugene	Stepson	16	
15	06B	70	Rural Boyd Area	Inman	J. M. (James Madison)	Head	67	Farmer, Agriculture
15	06B	71	Rural Boyd Area	Inman	Lou (Venia Wilkinson)	Wife	66	

1940 ED 15 Newark Town and Boyd Area

ED	Page	Line	Location	Last Name	First Name (Additional Information)	Relation	Age	Occupation
15	06B	72	Rural Boyd Area	Thompson	D. B. (David Baty)	Head	50	Farmer, Agriculture
15	06B	73	Rural Boyd Area	Vess	Floyd R. (Redford)	Head	38	Farmer, Agriculture
15	06B	74	Rural Boyd Area	Vess	Ima (Jean Gaston)	Wife	37	
15	06B	75	Rural Boyd Area	Vess	Blanche	Daughter	19	
15	06B	76	Rural Boyd Area	Vess	Carroll	Son	17	Farmer, Agriculture
15	06B	77	Rural Boyd Area	Vess	Auldon	Son	14	Farmer, Agriculture
15	06B	78	Rural Boyd Area	Vess	Dorothy Dail (Dale)	Daughter	12	
15	06B	79	Rural Boyd Area	Vess	Ethel	Daughter	8	
15	06B	80	Rural Boyd Area	Vess	Helen (Jean)	Daughter	1	
15	07A	01	Rural Boyd Area	King	James M.	Head	60	Farmer, Agriculture
15	07A	02	Rural Boyd Area	King	Martha	Wife	55	
15	07A	03	Rural Boyd Area	King	Winston H.	Son	25	Farmer, Agriculture
15	07A	04	Rural Boyd Area	King	Louis	Son	18	Farmer, Agriculture
15	07A	05	Rural Boyd Area	Williams	J. H. (James)	Head	62	Farmer, Agriculture
15	07A	06	Rural Boyd Area	Williams	Vanna (Cash)	Wife	41	
15	07A	07	Rural Boyd Area	Williams	Lillie Mae	Daughter	10	
15	07A	08	Rural Boyd Area	Williams	James Henry	Son	7	
15	07A	09	Rural Boyd Area	Divine	J. D.	Head	22	Laborer, WPA Road Project
15	07A	10	Rural Boyd Area	Divine	Annie (Lorene Reeves)	Wife	22	
15	07A	11	Rural Boyd Area	Cash	E. A. (Emmett Alexander)	Head	53	Farmer, Agriculture
15	07A	12	Rural Boyd Area	Cash	Volina (E. Lefors)	Wife	50	
15	07A	13	Rural Boyd Area	Judson	Joseph	Head	60	Farmer (retired), Agriculture
15	07A	14	Rural Boyd Area	Judson	Etta	Wife	41	
15	07A	15	Rural Boyd Area	Judson	Melva	Daughter	17	
15	07A	16	Rural Boyd Area	Judson	Melton	Son	15	
15	07A	17	Rural Boyd Area	Scroggins	A. J. (Andrew Jackson)	Head	60	Attendant & bus driver, Service Statio & High School
15	07A	18	Rural Boyd Area	Scroggins	Ora B. (Oradell Cornstubble)	Wife	57	
15	07A	19	Rural Boyd Area	Scroggins	A. W. (Andrew Wayne)	Son	37	Mechanic, Engineering
15	07A	20	Rural Boyd Area	Scroggins	Roberta (Lee Kirkland)	Daughter-in-law	19	
15	07A	21	Rural Boyd Area	Scroggins	Andrew Jackson	Grandson	2	
15	07A	22	Rural Boyd Area	Scroggins	Joyce Ann	Granddaughter	1	
15	07A	23	Rural Boyd Area	Scroggins	James Lee	Son	37	
15	07A	24	Rural Boyd Area	Scroggins	Jackson Glen	Son	27	
15	07A	25	Rural Boyd Area	Williams	L. W.	Head	35	Farmer, Agriculture
15	07A	26	Rural Boyd Area	Williams	Addie Belle (Scroggins)	Wife	29	
15	07A	27	Rural Boyd Area	Williams	Billy Ray	Son	4	
15	07A	28	Rural Boyd Area	Williams	Bobbie Gene	Son	2	
15	07A	29	Rural Boyd Area	Burleson	J.	Head	54	Farmer, Agriculture
15	07A	30	Rural Boyd Area	Burleson	Rena	Wife	43	
15	07A	31	Rural Boyd Area	Washburn	L. A. (Lawrence)	Head	41	Farmer, Agriculture
15	07A	32	Rural Boyd Area	Washburn	Mary Kate	Wife	32	
15	07A	33	Rural Boyd Area	Washburn	Viola (M.)	Daughter	14	
15	07A	34	Rural Boyd Area	Washburn	Paul (B.)	Son	12	
15	07A	35	Rural Boyd Area	Washburn	Albert	Son	10	
15	07A	36	Rural Boyd Area	Washburn	Ruth	Daughter	8	
15	07A	37	Rural Boyd Area	Washburn	Wanda Fay	Daughter	6	
15	07A	38	Rural Boyd Area	Caldwell	J. F. (Joseph Floyd)	Head	53	Farmer, Agriculture
15	07A	39	Rural Boyd Area	Caldwell	Fanny Long	Wife	56	
15	07A	40	Rural Boyd Area	Caldwell	Mollie Ann (Mary Ann Fagg)	Mother	82	
15	07B	41	Rural Boyd Area	Drake	J. W.	Head	51	Farmer, Agriculture
15	07B	42	Rural Boyd Area	Drake	Mary	Wife	51	
15	07B	43	Rural Boyd Area	Drake	Ruth	Daughter	16	

1940 ED 15 Newark Town and Boyd Area

ED	Page	Line	Location	Last Name	First Name (Additional Information)	Relation	Age	Occupation
15	07B	44	Rural Boyd Area	Stanford	Bessie (Patterson)	Head	39	
15	07B	45	Rural Boyd Area	Stanford	Clifford	Son	15	Farm helper, Agriculture
15	07B	46	Rural Boyd Area	Stanford	Harold	Son	13	
15	07B	47	Rural Boyd Area	Stanford	Roy	Son	11	
15	07B	48	Rural Boyd Area	Stanford	Betty (Jo)	Daughter	9	
15	07B	49	Rural Boyd Area	Stanford	Joe	Son	8	
15	07B	50	Rural Boyd Area	Stanford	Ruth	Daughter	5	
15	07B	51	Rural Boyd Area	Stanford	Yvonne	Daughter	4	
15	07B	52	Rural Boyd Area	Stanford	Vera (Lucille)	Daughter	2	
15	07B	53	Rural Boyd Area	Hall	J. H. (Jack)	Head	24	Smutter, Flour Mill
15	07B	54	Rural Boyd Area	Hall	Foye L.(Lindle Scroggins)	Wife	22	
15	07B	55	Rural Boyd Area	Hall	Linda Jean	Daughter	2	
15	07B	56	Rural Boyd Area	Hall	Norma Elizabeth	Daughter	0/12	
15	07B	57	Rural Boyd Area	Scroggins	Eugene (no middle name)	Head	33	Mechanic, Private Garage
15	07B	58	Rural Boyd Area	Scroggins	Mildred (Edith Lynch)	Wife	21	
15	07B	59	Rural Boyd Area	Scroggins	Delorice (Eleanore Findeisin)	Daughter	2	
15	07B	60	Rural Boyd Area	Scroggins	Delbert (Eugene)	Son	4/12	
15	07B	61	Rural Boyd Area	Inman	W. C. (Willie Cowan)	Head	38	Farmer, Agriculture
15	07B	62	Rural Boyd Area	Inman	Cleo (Addie Cleo Alexander)	Wife	34	
15	07B	63	Rural Boyd Area	Inman	Roy	Son	15	
15	07B	64	Rural Boyd Area	Inman	Ralph	Son	14	
15	07B	65	Rural Boyd Area	Inman	Billy Sue (Latham Hudson)	Daughter	12	
15	07B	66	Rural Boyd Area	Inman	Jacqueline (Louise)	Daughter	10	
15	07B	67	Rural Boyd Area	Inman	Velta Mae (McNutt)	Daughter	7	
15	07B	68	Rural Boyd Area	Inman	Cora, Mrs.	Head	50	
15	07B	69	Rural Boyd Area	Hines	James D. (David)	Head	40	Truck Driver, WPA School Project
15	07B	70	Rural Boyd Area	Hines	Mary (E. Stanford)	Wife	22	
15	07B	71	Rural Boyd Area	Hines	James Edward	Son	2	
15	07B	72	Rural Boyd Area	Hines	David Earl	Son	1/12	
15	07B	73	Rural Boyd Area	Keathley	Ora	Head	58	
15	07B	74	Rural Boyd Area	Keathley	Etma	Daughter	37	
15	07B	75	Rural Boyd Area	Keathley	Bennie	Son	33	Laborer, WPA Road Project
15	07B	76	Rural Boyd Area	Keathley	Gladys	Daughter	31	Clerk, General Store
15	07B	77	Rural Boyd Area	Waggoner	C. E.	Head	35	Poultry Man, Chicken
15	07B	78	Rural Boyd Area	Waggoner	Lena	Wife	46	
15	07B	79	Rural Boyd Area	Huff	T. B. (Thomas Bell)	Head	67	
15	07B	80	Rural Boyd Area	Huff	Minnie (Prudy Hollis)	Wife	58	
15	08A	01	Rural Boyd Area	Huff	Elvie	Son	21	Farmer, Agriculture
15	08A	02	Rural Boyd Area	Huff	Jackie Ray	Son	13	
15	08A	03	Rural Boyd Area	Huff	Armasone (Amanda Carolyn Bradley)	Mother	92	
15	08A	04	Rural Boyd Area	Smith	G. E.	Head	53	Merchant, General Store
15	08A	05	Rural Boyd Area	Garrett	John	Head	40	Laborer, General Work
15	08A	06	Rural Boyd Area	Garrett	Willie	Wife	45	
15	08A	07	Rural Boyd Area	Garrett	Abner Odell	Son	18	Laborer, General Work
15	08A	08	Rural Boyd Area	Garrett	Bertie R.	Daughter	14	
15	08A	09	Rural Boyd Area	Garrett	Walter J.	Son	10	
15	08A	10	Rural Boyd Area	Tidwell	H. E.	Head	70	
15	08A	11	Rural Boyd Area	Tidwell	Martha	Wife	66	
15	08A	12	Rural Boyd Area	Mercer	T. H. (Tom)	Head	70	
15	08A	13	Rural Boyd Area	Mercer	Belle (A. Scroggins)	Wife	64	
15	08A	14	Rural Boyd Area	Mercer	J. E. (Edd J.)	Son	45	Farmer, Agriculture
15	08A	15	Rural Boyd Area	Mercer	Bessie	Daughter	39	

1940 ED 15 Newark Town and Boyd Area

ED	Page	Line	Location	Last Name	First Name (Additional Information)	Relation	Age	Occupation
15	08A	16	Rural Boyd Area	Hardee	Sam (Samuel Brooks)	Head	50	Farmer, Agriculture
15	08A	17	Rural Boyd Area	Hardee	Ella (Maude Ella Covington)	Wife	49	
15	08A	18	Rural Boyd Area	Hardee	Edward	Son	20	Laborer, WPA Construction Project
15	08A	19	Rural Boyd Area	Hardee	Frank	Son	15	Farmer's helper, Father's Farm
15	08A	20	Rural Boyd Area	Hardee	Jessie Mae	Daughter	11	
15	08A	21	Rural Boyd Area	Hardee	Hattie (Brouxe)	Daughter	7	
15	08A	22	Rural Boyd Area	Hardee	Willie (Lee)	Daughter	7	
15	08A	23	Rural Boyd Area	Roberson	A. R. (Albert Ray "Dick")	Head	45	Farmer, Agriculture
15	08A	24	Rural Boyd Area	Roberson	Frances (Cozby)	Mother	78	
15	08A	25	Rural Boyd Area	Tidwell	Dessie (Robinson)	Sister	39	
15	08A	26	Rural Boyd Area	Tidwell	Wilburn	Nephew	5	
15	08A	27	Rural Boyd Area	Newby	Charlie (Charles Simmons)	Head	47	Laborer, General Work
15	08A	28	Rural Boyd Area	Newby	Nellie (Person)	Wife	44	
15	08A	29	Rural Boyd Area	Newby	Milas (Edward)	Son	12	
15	08A	30	Rural Boyd Area	Waggoner	Wiley	Head	54	Laborer, WPA Road Project
15	08A	31	Rural Boyd Area	Waggoner	Cora	Wife	44	
15	08A	32	Rural Boyd Area	Heffington	Durwood	Stepson	24	Carpenter, General Work
15	08A	33	Rural Boyd Area	Waggoner	John Van	Son	11	
15	08A	34	Rural Boyd Area	Waggoner	Jessie Lee	Son	6	
15	08A	35	Rural Boyd Area	McKinney	L. C. (Lawton Clifford, Sr.)	Head	48	Farmer, Agriculture
15	08A	36	Rural Boyd Area	McKinney	Goldie (Belle Seely)	Wife	45	
15	08A	37	Rural Boyd Area	McKinney	James (F.)	Son	20	Farmer, Agriculture
15	08A	38	Rural Boyd Area	McKinney	Orveta (Leota M.)	Daughter	17	Waitress, School Dining Room
15	08A	39	Rural Boyd Area	McKinney	L. C. (Lawton Clifford Jr.)	Son	14	
15	08A	40	Rural Boyd Area	McKinney	Jerry (C.)	Son	12	
15	08B	41	Rural Boyd Area	McKinney	Myrtle (Roena Darlene)	Daughter	10	
15	08B	42	Rural Boyd Area	McKinney	Obie Leon	Son	5	
15	08B	43	Rural Boyd Area	Beaver	L. J. (Leonard)	Head	61	Farmer, Agriculture
15	08B	44	Rural Boyd Area	Beaver	Nancy (A.)	Wife	61	
15	08B	45	Rural Boyd Area	Forbes	Salena (R.)	Head	71	
15	08B	46	Rural Boyd Area	Robertson/Robinson	Myrtle	Daughter	49	
15	08B	47	Rural Boyd Area	Cunningham	Valeria	Head	52	Merchant, General Store
15	08B	48	Rural Boyd Area	Robinson/Robertson	Marvin (C.)	Nephew	22	Merchant, General Store
15	08B	49	Rural Boyd Area	Wright	Cora (Lee Vessels)	Head	60	
15	08B	50	Rural Boyd Area	Wright	Earl (T.)	Son	31	Farmer, Agriculture
15	08B	51	Rural Boyd Area	Wright	Jessie Eugene	Head	41	Laborer, WPA Road Project
15	08B	52	Rural Boyd Area	Wright	Bertha Lee (Hayes)	Wife	45	
15	08B	53	Rural Boyd Area	Wright	Eldon (Melvin E.)	Son	16	Farmer, Agriculture
15	08B	54	Rural Boyd Area	Wright	Alta (N)	Daughter	14	
15	08B	55	Rural Boyd Area	Wright	Wilma (E.)	Daughter	12	
15	08B	56	Rural Boyd Area	Wright	Kenneth	Son	9	
15	08B	57	Rural Boyd Area	Wright	Erma Lee	Daughter	8	
15	08B	58	Rural Boyd Area	Wright	Jo Ann	Daughter	6	
15	08B	59	Rural Boyd Area	Wilkerson	Leon	Head	38	Farmer, Agriculture
15	08B	60	Rural Boyd Area	Wilkerson	Leo	Son	14	Farmer, Agriculture
15	08B	61	Rural Boyd Area	Collum	Ben	Head	54	This person is now in prison.
15	08B	62	Rural Boyd Area	Collum	Willie Mae	Head	38	
15	08B	63	Rural Boyd Area	Collum	Hubert Lee	Son	16	
15	08B	64	Rural Boyd Area	Collum	Genie	Son	14	
15	08B	65	Rural Boyd Area	Collum	Laura Mae	Daughter	12	
15	08B	66	Rural Boyd Area	Collum	Jesse	Son	6	
15	08B	67	Rural Boyd Area	Collum	Charlie	Son	2	

1940 ED 15 Newark Town and Boyd Area

ED	Page	Line	Location	Last Name	First Name (Additional Information)	Relation	Age	Occupation
15	08B	68	Rural Boyd Area	Callaway	J. E.	Head	53	Farmer, Agriculture
15	08B	69	Rural Boyd Area	Callaway	Judith	Wife	40	
15	08B	70	Rural Boyd Area	Hunter	W. B.	Head	56	Farmer, Agriculture
15	08B	71	Rural Boyd Area	Hunter	Maude	Wife	52	
15	08B	72	Rural Boyd Area	Hunter	J. C.	Son	17	
15	08B	73	Rural Boyd Area	Ford	J. W. (Joseph)	Head	70	Farmer, Agriculture
15	08B	74	Rural Boyd Area	Ford	Dora	Wife	56	
15	08B	75	Rural Boyd Area	Taylor	Milton	Head	64	Farmer, Agriculture
15	08B	76	Rural Boyd Area	Taylor	Ettie Mae (May)	Wife	60	
15	08B	77	Rural Boyd Area	Taylor	James	Son	39	Farmer, Agriculture
15	08B	78	Rural Boyd Area	Taylor	Thomas	Son	34	Farmer, Agriculture
15	08B	79	Rural Boyd Area	Taylor	Bernice	Daughter	19	
15	08B	80	Rural Boyd Area	Taylor	Odessa	Daughter	17	
15	09A	01	Rural Boyd Area	Taylor	J. W.	Son	14	Farmer, Agriculture
15	09A	02	Rural Boyd Area	Alexander	A. D. (Ausie)	Head	53	Laborer, WPA Road Project
15	09A	03	Rural Boyd Area	Alexander	Emmie (B.)	Wife	43	
15	09A	04	Rural Boyd Area	Alexander	Veta Mae (Vata)	Daughter	17	
15	09A	05	Rural Boyd Area	Alexander	B. F.	Son	10	
15	09A	06	Rural Boyd Area	Rickman	C. W. (Charles)	Head	55	Farmer, Agriculture
15	09A	07	Rural Boyd Area	Rickman	Rose (Roseta M.)	Wife	55	
15	09A	08	Rural Boyd Area	Rickman	Roberta	Daughter	27	Teacher. Public School
15	09A	09	Rural Boyd Area	Waggoner	D. D.(Delmar Dwain)	Head	28	Poultry Man, Chicken
15	09A	10	Rural Boyd Area	Waggoner	D'Alda (Oleta Bradley)	Wife	26	
15	09A	11	Rural Boyd Area	Waggoner	Billy (Delmar)	Son	2	
15	09A	12	Rural Boyd Area	Smith	E. L. (Elgin Lee, Sr.)	Head	40	Farmer, Agriculture
15	09A	13	Rural Boyd Area	Smith	Mae (Lydia May Swinney)	Wife	35	
15	09A	14	Rural Boyd Area	Smith	Annavell	Daughter	18	
15	09A	15	Rural Boyd Area	Smith	Bernice	Daughter	16	
15	09A	16	Rural Boyd Area	Smith	Imogene	Daughter	12	
15	09A	17	Rural Boyd Area	Smith	E. L. (Elgin Lee, Jr)	Son	9	
15	09A	18	Rural Boyd Area	Smith	Juannell	Daughter	7	
15	09A	19	Rural Boyd Area	Smith	Billy (Gilford)	Son	4	
15	09A	20	Rural Boyd Area	Smith	Charles Ray	Son	2	
15	09A	21	Rural Boyd Area	Smith	Jackie Doyle	Son	1	
15	09A	22	Rural Boyd Area	Donaldson	H. R. (Homer)	Head	61	Farmer, Agriculture
15	09A	23	Rural Boyd Area	Donaldson	Lela (Leta Lee)	Wife	57	
15	09A	24	Rural Boyd Area	Alexander	W. L. (William)	Hired Hand	18	Farmer, Agriculture
15	09A	25	Rural Boyd Area	Thom	W. W.	Head	53	Farmer, Agriculture
15	09A	26	Rural Boyd Area	Cash	Joe	Head	45	Farmer, Agriculture
15	09A	27	Rural Boyd Area	Cash	John (Wesley)	Father	77	
15	09A	28	Rural Boyd Area	Pickett	L. O.	Head	37	Dairy Farmer, Dairy
15	09A	29	Rural Boyd Area	Pickett	Winnie Lill	Wife	33	
15	09A	30	Rural Boyd Area	Pickett	Wynoma	Daughter	14	
15	09A	31	Rural Boyd Area	Pickett	Dortha Dell	Daughter	13	
15	09A	32	Rural Boyd Area	Pickett	Janice	Daughter	6	
15	09A	33	Rural Boyd Area	Pickett	Janette	Daughter	6	
15	09A	34	Rural Boyd Area	Pickett	Iola Faye	Daughter	4	
15	09A	35	Rural Boyd Area	Pickett	Emma Jane	Daughter	6/12	
15	09A	36	Rural Boyd Area	Sumrall	B. C.	Head	30	Dairyman, Dairy
15	09A	37	Rural Boyd Area	Sumrall	Theo	Wife	27	
15	09A	38	Rural Boyd Area	Sumrall	Viola Jo	Daughter	10	
15	09A	39	Rural Boyd Area	Sumrall	A. C.	Son	7	

1940 ED 15 Newark Town and Boyd Area

	ED Page	Line	Location	Last Name	First Name (Additional Information)	Relation	Age	Occupation
15	09A	40	Rural Boyd Area	Cash	Felix	Head	34	Laborer, WPÅ Road Project
15	09B	41	Rural Boyd Area	Cash	Mattie (Lou Smith)	Wife	32	
15	09B	42	Rural Boyd Area	Cash	Gladys (W.)	Daughter	15	
15	09B	43	Rural Boyd Area	Cash	Jo Earlene	Daughter	13	
15	09B	44	Rural Boyd Area	Cash	James Arnold	Son	4	
15	09B	45	Rural Boyd Area	Cash	Billy (Billie Maudine)	Daughter	1	
15	09B	46	Rural Boyd Area	Coe	I. D.	Head	68	Laborer, Woodcutting
15	09B	47	Rural Boyd Area	Coe	Henry	Son	16	
15	09B	48	Rural Boyd Area	Scroggins	H. D. (Hamilton "Ham")	Head	31	Tractor Driver, Road Construction
15	09B	49	Rural Boyd Area	Scroggins	Vera Lee	Wife	24	
15	09B	50	Rural Boyd Area	Byrom	Tom (A.)	Head	55	Farmer, Agriculture
15	09B	51	Rural Boyd Area	Byrom	Maudie (A. Gilmore)	Wife	49	
15	09B	52	Rural Boyd Area	Brown	James (A.)	Head	36	Laborer, WPÅ Road Project
15	09B	53	Rural Boyd Area	Brown	Myrtle (E. Slimp)	Wife	29	
15	09B	54	Rural Boyd Area	Brown	Marie	Daughter	8	
15	09B	55	Rural Boyd Area	Lawrence	Daisy (S.)	Head	48	Farmer, Agriculture
15	09B	56	Rural Boyd Area	White	Bert (A. E.)	Head	54	Farmer, Agriculture
15	09B	57	Rural Boyd Area	White	Minnie (E.)	Wife	53	
15	09B	58	Rural Boyd Area	White	Barney	Son	18	
15	09B	59	Rural Boyd Area	White	Bennie Sue	Daughter	12	
15	09B	60	Rural Boyd Area	Brown	A. C.	Head	58	Farmer, Agriculture
15	09B	61	Rural Boyd Area	Brown	Clara	Wife	57	
15	09B	62	Rural Boyd Area	Brown	William		30	Farmer, Agriculture
15	09B	63	Rural Boyd Area	Williams	H.B. (Holiday Burch "Doc")	Head	40	Farmer, Agriculture
15	09B	64	Rural Boyd Area	Williams	C. A. (Adeline Sewell)	Mother	68	
15	09B	65	Rural Boyd Area	Smith	W. T. (Walter Thomas)	Head	53	Farmer, Agriculture
15	09B	66	Rural Boyd Area	Smith	Mattie (M. May)	Wife	49	
15	09B	67	Rural Boyd Area	Smith	Arvil	Son	29	Farmer, Agriculture
15	09B	68	Rural Boyd Area	Smith	Verna Ruth	Daughter-in-law	24	
15	09B	69	Rural Boyd Area	Taylor	D. L.	Head	48	Farmer, Agriculture
15	09B	70	Rural Boyd Area	Taylor	Anna	Wife	44	
15	09B	71	Rural Boyd Area	Taylor	Opal	Daughter	17	
15	09B	72	Rural Boyd Area	Taylor	J. D.	Son	15	
15	09B	73	Rural Boyd Area	Rainey	J. H.	Head	55	Farmer, Agriculture
15	09B	74	Rural Boyd Area	Rainey	Alice	Wife	50	
15	09B	75	Rural Boyd Area	Smith	M. S., Mrs.	Head	59	Farm Manager, Agriculture
15	09B	76	Rural Boyd Area	Carly	Nell	Lodger	36	
15	09B	77	Rural Boyd Area	Carly	Tammie Jo	Lodger's Daughter	17	
15	09B	78	Rural Boyd Area	Callium	LeRoy	Hired Hand	34	Farmer, Agriculture
15	10A	01	Newark Town	Haynes	Julia (Ferguson)	Head	50	
15	10A	02	Newark Town	Haynes	Wade	Son	23	Truck Driving, Transfer
15	10A	03	Newark Town	Haynes	Jack	Son	15	
15	10A	04	Newark Town	Helm	E. M. (Earl Monroe)	Head	36	Section Foreman, Railroad
15	10A	05	Newark Town	Helm	Bernice (Fay Hanes)	Wife	33	
15	10A	06	Newark Town	Helm	Bennie (Bennie Earl)	Son	13	
15	10A	07	Newark Town	Laster	W. H. (Hugh W.)	Head	61	Farmer, Agriculture
15	10A	08	Newark Town	Laster	Vesta	Wife	40	
15	10A	09	Newark Town	Hudson	R. A. (Robert)	Head	74	Merchant, General Store
15	10A	10	Newark Town	Hudson	Ora (C. Earp)	Wife	62	
15	10A	11	Newark Town	Wilson	Jack	Head	27	Farmer, Cattle & Agriculture
15	10A	12	Newark Town	Wilson	Sarah	Wife	21	
15	10A	13	Newark Town	Beauchamp	H. B. (Herschel)	Head	21	Farmer, Agriculture

1940 ED 15 Newark Town and Boyd Area

ED	Page	Line	Location	Last Name	First Name (Additional Information)	Relation	Age	Occupation
15	10A	14	Newark Town	Beauchamp	Juanita (Katherine Bradley)	Wife	21	
15	10A	15	Newark Town	Beauchamp	Robert (Herschel)	Son	11/12	
15	10A	16	Newark Town	Kimtriel	C. W.	Head	47	Fireman, Railroad
15	10A	17	Newark Town	Kimtriel	Gertie	Wife	40	
15	10A	19	Newark Town	Payne	Martha (Adelphus Palmer "Mattie")	Head	69	
15	10A	20	Newark Town	Payne	Hoy (G, Sr.)	Head	33	Laborer, General Work
15	10A	21	Newark Town	Payne	Ruth	Wife	32	
15	10A	22	Newark Town	Payne	Hoy Jr. (C.)	Son	3	
15	10A	23	Newark Town	Beauchamp	Vance (J. Vance)	Head	48	Carpenter, Building
15	10A	24	Newark Town	Beauchamp	Exa (Boyd)	Wife	45	
15	10A	25	Newark Town	Beauchamp	Carl	Son	21	Farming, Agriculture
15	10A	26	Newark Town	Beauchamp	Conrad (Vance)	Son	11	
15	10A	27	Newark Town	Roberts	Eula	Lodger	39	
15	10A	28	Newark Town	Helm	George	Head	41	Laborer, WPA Construction Work
15	10A	29	Newark Town	Helm	Bernice	Wife	30	
15	10A	30	Newark Town	Helm	Barbara	Daughter	6	
15	10A	31	Newark Town	Helm	Howard Lee	Son	4	
15	10A	32	Newark Town	Harvey	Edward (L.)	Head	21	Clerk, Grocery & Service Station
15	10A	33	Newark Town	Harvey	Iva (J.)	Mother	49	
15	10A	34	Newark Town	Slimp	Alice (Harvey)	Sister	26	
15	10A	35	Newark Town	Slimp	Glenda	Niece	5	
15	10A	36	Newark Town	Hudson	M. N. (Mancil)	Head	71	Farmer (Retired), Agriculture
15	10A	37	Newark Town	Hudson	Sally (T. Harrison)	Wife	55	
15	10A	38	Newark Town	Johnston	G. E. (George Eugene)	Head	50	Blacksmith, Construction
15	10A	39	Newark Town	Johnston	Donnie (Lois Moyer)	Wife	42	Switchboard Operator, Telephone
15	10A	40	Newark Town	Johnston	Beatrice (B.)	Daughter	16	
15	10B	41	Newark Town	Johnston	Imogene (Grace)	Daughter	14	
15	10B	42	Newark Town	Beauchamp	Vernon	Head	52	Clerk, General Store
15	10B	43	Newark Town	Beauchamp	Della (Boyd)	Wife	44	
15	10B	44	Newark Town	Boyd	L., Mrs.	Mother-in-law	64	
15	10B	45	Newark Town	Buck	Lodema	Head	66	
15	10B	46	Newark Town	Miller	Eliza	Sister	78	
15	10B	47	Newark Town	Hill	H. F.	Head	47	Merchant, General Store & Service Station
15	10B	48	Newark Town	Hill	Myrtle	Wife	47	
15	10B	49	Newark Town	Bruce	C. H.	Head	41	Track Foreman, Railroad
15	10B	50	Newark Town	Bruce	Lola	Wife	36	
15	10B	51	Newark Town	Evans	Memory	Head	35	Laborer, WPA Building Project
15	10B	52	Newark Town	Evans	Thelma	Wife	27	
15	10B	53	Newark Town	Evans	Ilamae	Daughter	14	
15	10B	54	Newark Town	Evans	Arthur (David)	Head	20	Laborer, WPA Building Project
15	10B	55	Newark Town	Evans	Annie Pearl (Garrett)	Wife	20	
15	10B	56	Newark Town	Evans	Frances Ann	Daughter	1	
15	10B	57	Newark Town	Drain	Edward	Head	21	Laborer, Railroad
15	10B	58	Newark Town	Drain	Lucille	Wife	26	
15	10B	59	Newark Town	Bruner	S. B. (Silas Bailey "Dike")	Head	36	Laborer, Railroad
15	10B	60	Newark Town	Bruner	Letha (Lee Dickenson)	Wife	32	
15	10B	61	Newark Town	Bruner	Billy Faye (Billie)	Daughter	12	
15	10B	62	Newark Town	Bruner	Loyd Ray	Son	9	
15	10B	63	Newark Town	Bruner	Gordon	Son	6	
15	10B	64	Newark Town	Beauchamp	Herman	Head	25	Merchant, Grocery
15	10B	65	Newark Town	Beauchamp	Nova	Wife	23	
15	10B	66	Newark Town	Beauchamp	Janice	Daughter	1	

1940 ED 15 Newark Town and Boyd Area

ED	Page	Line	Location	Last Name	First Name (Additional Information)	Relation	Age	Occupation
15	10B	67	Newark Town	Evans	J. B. (Jim)	Head	56	Laborer, WPA Building Project
15	10B	68	Newark Town	Evans	Mary (R.)	Wife	57	
15	10B	69	Newark Town	Evans	Billy (W.)	Son	14	
15	10B	70	Newark Town	Evans	Anna Sarah	Daughter	9	
15	10B	71	Newark Town	Scroggins	Alma	Head	55	
15	10B	72	Newark Town	Bailey	J. A. (Joseph)	Father	90	
15	10B	73	Newark Town	Drain	Artie (Edward)	Son-in-law	28	Truck Driver, Transfer
15	10B	74	Newark Town	Drain	Reba (Scroggins)	Daughter	27	
15	10B	75	Newark Town	Palmer	E. L. (Edd, Sr.)	Head	55	Laborer, General Work
15	10B	76	Newark Town	Palmer	Edith (E.)	Wife	45	
15	10B	77	Newark Town	Palmer	E. L. Jr. (Edd)	Son	21	Laborer, General Work
15	10B	78	Newark Town	Palmer	Harold E.	Son	18	Infirmiry, Dispensary
15	10B	79	Newark Town	Palmer	Alene (Alleen C.)	Daughter	14	
15	10B	80	Newark Town	Sampson	Sabra	Head	71	
15	11A	01	Newark Town	Galtorena	Mae (Sampson)	Daughter	48	
15	11A	02	Newark Town	Galtorena	Mark	Granddaughter	19	
15	11A	03	Newark Town	Hiett	Leone	Head	71	
15	11A	04	Newark Town	Royas	John	Head	62	Laborer, WPA Reconstruction
15	11A	05	Newark Town	Royas	Nanny	Wife	67	
15	11A	06	Newark Town	Evans	R. B.	Head	29	Laborer, WPA Construction
15	11A	07	Newark Town	Evans	Mary	Wife	21	
15	11A	08	Newark Town	Evans	Robert	Son	2	
15	11A	09	Newark Town	Brown	S. J. (Sam)	Head	46	Laborer, WPA Construction
15	11A	10	Newark Town	Brown	Carrie (Florence Burns)	Wife	41	
15	11A	11	Newark Town	Brown	Sarah (E.)	Daughter	19	Housekeeper, Private Home
15	11A	12	Newark Town	Brown	Nettie (A.)	Daughter	17	Housekeeper, Private Home
15	11A	13	Newark Town	Brown	Dean Howard	Son	13	
15	11A	14	Newark Town	Brown	Bennie (Samuel)	Son	11	
15	11A	15	Newark Town	Childress	A. R. (Alfred)	Head	83	Retired Farmer, Agriculture
15	11A	16	Newark Town	Childress	Kizzie (E. Baldwin)	Wife	51	
15	11A	17	Newark Town	Childress	L. T. (Luther)	Son	18	
15	11A	18	Newark Town	Childress	Jannie (Janie Evelyn)	Daughter	13	
15	11A	19	Newark Town	Childress	Bob (William O.)	Son	28	Laborer, WPA Construction
15	11A	20	Newark Town	Doughty	G. W. (Henry W.)	Head	77	Mail Messenger, Postal
15	11A	21	Newark Town	Doughty	Rella	Wife	49	Postmaster, Postal
15	11A	22	Newark Town	Doughty	G. W.	Son	18	
15	11A	23	Newark Town	Wilkinson	F. L.	Head	60	Merchant, Café
15	11A	24	Newark Town	Wilkinson	Nell	Wife	54	Waitress, Café
15	12A	01	Page 61A-Boyd Area	Brown	Foy E. (Elmer)	Head	25	Laborer, NYA Job
15	12A	02	Page 61A-Boyd Area	Brown	F. E., Mrs. (Mableanne Taylor)	Wife	23	
15	12A	03	Page 61A-Boyd Area	Stephens	C. C. (Charlie)	Head	47	Farmer, Agriculture
15	12A	04	Page 61A-Boyd Area	Stephens	Lorene	Wife	27	
15	12A	05	Page 61A-Boyd Area	Stephens	Thomas	Son	7/12	
15	12A	06	Page 61A-Boyd Area	Tedrow	W. H.	Head	56	Farmer, Agriculture
15	12A	07	Page 61A-Boyd Area	Tedrow	Alma	Wife	54	
15	12A	08	Page 61A-Boyd Area	Tedrow	Alta	Daughter	25	
15	12A	09	Page 61A-Boyd Area	Tedrow	Deward	Son	19	Laborer, Work of all kinds
15	12A	10	Page 61A-Boyd Area	Tedrow	Warren	Son	13	
15	12A	11	Page 61A-Boyd Area	Stokes	Oscar (A.)	Head	27	Farmer, Agriculture
15	12A	12	Page 61A-Boyd Area	Stokes	Adrian	Wife	20	
15	12A	13	Page 61A-Boyd Area	Stokes	Billy Charles	Nephew	16	Farmer, Agriculture
15	12A	14	Page 61A-Boyd Area	Stokes	Mirron Lee (Marion)	Nephew	11	

Index of Names for 1940 Wise County TX Census - ED 15 Newark Town & Area Around Boyd

(864 Names - 102 are in the Town of Newark)

ED	Page	Line	Last Name	Given Name	ED	Page	Line	Last Name	Given Name	ED	Page	Line	Last Name	Given Name
15	12A	17	Able	A. A. (Astor Arlyce "Radio")	15	09B	61	Brown	Clara	15	07A	11	Cash	E. A. (Emmett Alexander)
15	12A	18	Able	Evelyn (Myra)	15	11A	13	Brown	Dean Howard	15	09A	40	Cash	Felix
15	05A	07	Able	Frank (Thomas Franklin)	15	01B	55	Brown	Ella (H.)	15	09B	42	Cash	Gladys (W.)
15	12A	19	Able	Jacqueline (Jackie)	15	12A	02	Brown	F. E., Mrs. (Mableanne Taylor)	15	09B	44	Cash	James Arnold
15	02A	19	Adams	J. P.	15	12A	01	Brown	Foy E. (Elmer)	15	09B	43	Cash	Jo Earlene
15	02A	20	Adams	Lena	15	09A	53	Brown	J. A.	15	09A	26	Cash	Joe
15	09A	02	Alexander	A. D. (Ausie)	15	01B	53	Brown	J. A.	15	09A	27	Cash	John (Wesley)
15	09A	05	Alexander	B. F.	15	09B	52	Brown	James (A.)	15	09B	41	Cash	Mattie (Lou Smith)
15	09A	03	Alexander	Emmie (B.)	15	09B	54	Brown	Marie	15	07A	12	Cash	Volina (E. Lefors)
15	09A	04	Alexander	Veta Mae (Vata)	15	01B	56	Brown	Mildred (F.)	15	02A	11	Cathey	James
15	09A	24	Alexander	W. L. (William)	15	09B	53	Brown	Myrtle (E. Slimp)	15	11A	15	Childress	A. R. (Alfred)
15	03B	52	Arrington	Betty Gene (Jean)	15	11A	12	Brown	Nettie (A.)	15	11A	19	Childress	Bob (William O.)
15	03B	49	Arrington	D. A. (Drew Alvin)	15	11A	09	Brown	S. J. (Sam)	15	11A	18	Childress	Jannie (Janie Evelyn)
15	03B	50	Arrington	Elva (Louise Walker)	15	11A	11	Brown	Sarah (E.)	15	11A	16	Childress	Kizzie (E. Baldwin)
15	03B	51	Arrington	Venita	15	01B	54	Brown	T. G. (Thomas)	15	11A	17	Childress	L. T. (Luther)
15	06B	62	Austin	D. F.	15	09B	62	Brown	William	15	02A	30	Cobb	E. A. (Elmer)
15	06B	64	Austin	Errett	15	10B	49	Bruce	C. H.	15	02A	38	Cobb	George
15	06B	63	Austin	Mary E.	15	10B	50	Bruce	Lola	15	02A	32	Cobb	John A.
15	06B	65	Austin	Nellie	15	10B	61	Bruner	Billy Faye (Billie)	15	02B	41	Cobb	Marion Lee Dale
15	10B	72	Bailey	J. A. (Joseph)	15	10B	63	Bruner	Gordon	15	02A	31	Cobb	Maudie Lee
15	03A	07	Baker	Alvin	15	10B	60	Bruner	Letha (Lee Dickenson)	15	02A	39	Cobb	Nettie Belle (Swafford)
15	03A	09	Baker	Billie Ray	15	10B	62	Bruner	Loyd Ray	15	02A	40	Cobb	Robert Cecil
15	03A	08	Baker	Evelyn	15	10B	59	Bruner	S. B. (Silas Bailey "Dike")	15	02B	42	Cobb	Roger Albert
15	04B	62	Bearden	Theodore	15	13A	07	Buck	????	15	09B	47	Coe	Henry
15	10A	25	Beauchamp	Carl	15	10B	45	Buck	Lodema	15	09B	46	Coe	I. D.
15	10A	26	Beauchamp	Conrad (Vance)	15	07A	29	Burleson	J.	15	06B	60	Cole	A. J. (Andrew Jackson)
15	10B	43	Beauchamp	Della (Boyd)	15	07A	30	Burleson	Rena	15	06B	61	Cole	Mytle
15	10A	24	Beauchamp	Exa (Boyd)	15	05B	62	Burnett	Betty	15	08B	61	Collum	Ben
15	10A	13	Beauchamp	H. B. (Herschel)	15	05B	64	Burnett	Betty Jo	15	08B	67	Collum	Charlie
15	10B	64	Beauchamp	Herman	15	05B	65	Burnett	Dortha Kay	15	08B	64	Collum	Genie
15	10B	66	Beauchamp	Janice	15	05B	50	Burnett	Douglas Henry	15	08B	63	Collum	Hubert Lee
15	10A	14	Beauchamp	Juanita (Katherine Bradley)	15	05B	47	Burnett	Etta Marie (Howe)	15	08B	66	Collum	Jesse
15	10B	65	Beauchamp	Nova	15	05B	46	Burnett	Henry R. (Pickney)	15	08B	65	Collum	Laura Mae
15	10A	15	Beauchamp	Robert (Herschel)	15	05B	61	Burnett	Marce	15	08B	62	Collum	Willie Mae
15	10A	23	Beauchamp	Vance (J. Vance)	15	05B	63	Burnett	Victor	15	03A	34	Cook	Betty Joe
15	10B	42	Beauchamp	Vernon	15	05A	31	Butler	Dorothy (V. Jackson)	15	03A	33	Cook	Dorothy Mae
15	08B	43	Beaver	L. J. (Leonard)	15	05A	32	Butler	Lola (D.)	15	03A	35	Cook	Lota
15	08B	44	Beaver	Nancy (A.)	15	05A	30	Butler	W. C. (William Cletus)	15	03A	31	Cook	Marvin (Chapel)
15	06A	24	Bolles	Denver	15	09B	51	Byrom	Maudie (A. Gilmore)	15	03A	36	Cook	Ray
15	06A	23	Bolles	Harley	15	09B	50	Byrom	Tom (A.)	15	03A	37	Cook	Sam (Houston)
15	10B	44	Boyd	L., Mrs.	15	01A	20	Caldwell	Burnie Lee (Mason)	15	03A	32	Cook	Urvel (Adams)
15	01B	66	Brammer	Lillie	15	07A	39	Caldwell	Fanny Long	15	03A	11	Cotton	Bernice
15	01B	65	Brammer	M. C.	15	01A	17	Caldwell	Foy Sue	15	03A	15	Cotton	Bobbie
15	01B	68	Brammer	Velma	15	01A	19	Caldwell	Homer J. (Jay)	15	03A	16	Cotton	Don (Lewis)
15	01B	67	Brammer	Viola Mae	15	01A	18	Caldwell	Joe (Ferguson)	15	03A	17	Cotton	Faye
15	01B	69	Brammer	Zelma	15	07A	38	Caldwell	J. F. (Joseph Floyd)	15	03A	18	Cotton	Freddie Faye
15	06A	18	Brawley	Boyd	15	01A	16	Caldwell	Joyce (Bessie Joyce)	15	03A	10	Cotton	H. L. (Henry)
15	06A	14	Brawley	Clarence	15	01A	18	Caldwell	Joyce (Bessie Joyce)	15	03A	12	Cotton	Jack
15	06A	15	Brawley	Hershel	15	07A	40	Caldwell	Mollie Ann (Mary Ann Fagg)	15	03A	14	Cotton	John
15	06A	20	Brawley	James Don	15	01A	14	Caldwell	Nova (Belle Bowman)	15	03A	13	Cotton	Ray
15	06A	17	Brawley	Joyce	15	01A	15	Caldwell	Warren G (W. G. Harding)	15	04B	52	Courtney	Selma
15	06A	19	Brawley	Melba	15	08B	68	Callaway	J. E.	15	04B	51	Courtney	H. M. (Harry)
15	06A	13	Brawley	Rosa Lee	15	08B	69	Callaway	Judith	15	08B	47	Cunningham	Valeria
15	06A	16	Brawley	Royce	15	09B	76	Callium	LeRoy	15	03B	60	Dickey	Marie
15	06A	12	Brawley	W. R. (Wesley)	15	09B	78	Carly	Nell	15	07A	10	Divine	Annie (Lorene Reeves)
15	02B	64	Bray	Anna Bell	15	09B	77	Carly	Tammie Jo	15	07A	09	Divine	J. D.
15	02B	65	Bray	Henry Lee	15	01A	37	Carswell	William	15	09A	22	Donaldson	H. R. (Homer)
15	09B	60	Brown	A. C.	15	09B	45	Cash	Billy (Billie Maudine)	15	09A	23	Donaldson	Lela (Leta Lee)
15	01B	57	Brown	Alberta	15	11A	14	Brown	Bennie (Samuel)	15	11A	22	Doughty	G. W.
15	11A	14	Brown	Bennie (Samuel)	15	11A	10	Brown	Carrie (Florence Burns)	15	11A	20	Doughty	G. W. (Henry W.)
15	11A	10	Brown	Carrie (Florence Burns)						15	11A	21	Doughty	Rella

Index of Names for 1940 Wise County TX Census - ED 15 Newark Town & Area Around Boyd

(864 Names - 102 are in the Town of Newark)

ED	Page	Line	Last Name	Given Name	ED	Page	Line	Last Name	Given Name	ED	Page	Line	Last Name	Given Name
15	04B	63	Drain	Archie (Lee)	15	05B	76	Freiley	June (Loui June)	15	10B	47	Hill	H. F.
15	10B	73	Drain	Artie (Edward)	15	05B	78	Freiley	Naida Rosa	15	10B	48	Hill	Myrtle
15	10B	57	Drain	Edward	15	05B	75	Freiley	Shirley (L.)	15	07B	72	Hines	David Earl
15	04B	64	Drain	Johnnie (Leonard McCrary)	15	01A	40	Fuller	Betty Joe	15	07B	69	Hines	James D. (David)
15	10B	58	Drain	Lucille	15	01A	38	Fuller	Jack	15	07B	71	Hines	James Edward
15	04B	65	Drain	Lucille (Jewell Lucile)	15	01A	39	Fuller	Nell	15	07B	70	Hines	Mary (E. Stanford)
15	10B	74	Drain	Reba (Scroggins)	15	11A	01	Galtorena	Mae (Sampson)	15	10A	36	Hudson	M. N. (Mancil)
15	04B	66	Drain	Thomas Atkins	15	11A	02	Galtorena	Mark	15	10A	10	Hudson	Ora (C. Earp)
15	07B	41	Drake	J. W.	15	08A	07	Garrett	Abner Odell	15	10A	09	Hudson	R. A. (Robert)
15	07B	42	Drake	Mary	15	08A	08	Garrett	Bertie R.	15	10A	37	Hudson	Sally (T. Harrison)
15	07B	43	Drake	Ruth	15	08A	05	Garrett	John	15	08A	03	Huff	Armasone (Amanda Carolyn Bradley)
15	01A	12	Eaton	Maurine	15	08A	09	Garrett	Walter J.	15	08A	01	Huff	Elvie
15	01A	13	Eaton	Roy	15	13A	05	Gillenwater	Jewel	15	12A	32	Huff	J. D. (James)
15	01A	11	Eaton	Virgil R.	15	02A	10	Green	Callie Mae	15	08A	02	Huff	Jackie Ray
15	02B	43	Ernest	Berl	15	02A	13	Green	Ella	15	12A	33	Huff	Jewel
15	02B	48	Ernest	Earl	15	02A	12	Green	L. T.	15	12A	34	Huff	Joyce
15	02B	45	Ernest	Evail	15	02A	09	Green	Lillard	15	07B	80	Huff	Minnie (Prudy Hollis)
15	02B	46	Ernest	James Earl	15	12A	26	Haggard	Ina (Pope)	15	07B	79	Huff	T. B. (Thomas Bell)
15	02B	44	Ernest	Opal	15	03A	01	Hague	C. I. (Columbus Iley)	15	05A	02	Hunn	Jack
15	02B	47	Ernest	Thomas Wayne	15	03A	04	Hague	Doris	15	05A	06	Hunn	Mary Ann
15	05B	56	Eubanks	Earnest (William, Sr.)	15	03A	03	Hague	Juanita	15	05A	01	Hunn	Reba (Moses)
15	05B	58	Eubanks	Earnest Jr. (William)	15	03A	02	Hague	Lizzie	15	05A	05	Hunn	Russel
15	05B	60	Eubanks	Elmer Joe	15	07B	54	Hall	Foye L. (Lindle Scroggins)	15	05A	03	Hunn	Terry
15	05B	59	Eubanks	Mary (Katherine)	15	07B	53	Hall	J. H. (Jack)	15	04B	80	Hunn	Tony R. (Toney Robert)
15	05B	57	Eubanks	Mattie (Leota Heard)	15	07B	55	Hall	Linda Jean	15	05A	04	Hunn	Van (T.)
15	10B	70	Evans	Anna Sarah	15	07B	56	Hall	Norma Elizabeth	15	08B	72	Hunter	J. C.
15	10B	55	Evans	Annie Pearl (Garrett)	15	06A	22	Hamilton	Mittie (Stone)	15	08B	71	Hunter	Maude
15	10B	54	Evans	Arthur (David)	15	06A	21	Hamilton	T. W. (Thomas William)	15	08B	70	Hunter	W. B.
15	10B	69	Evans	Billy (W.)	15	08A	18	Hardee	Edward	15	01B	45	Idell	Clyde
15	10B	56	Evans	Frances Ann	15	08A	17	Hardee	Ella (Maude Ella Covington)	15	01B	44	Idell	Harold
15	10B	53	Evans	Ilamae	15	08A	19	Hardee	Frank	15	01B	43	Idell	Marvin (M. A.)
15	10B	67	Evans	J. B. (Jim)	15	08A	21	Hardee	Hattie (Brouxe)	15	01B	46	Idell	Rosa
15	11A	07	Evans	Mary	15	08A	20	Hardee	Jessie Mae	15	07B	65	Inman	Billy Sue (Latham Hudson)
15	10B	68	Evans	Mary (R.)	15	08A	16	Hardee	Sam (Samuel Brooks)	15	07B	62	Inman	Cleo (Addie Cleo Alexander)
15	10B	51	Evans	Memory	15	08A	22	Hardee	Willie (Lee)	15	07B	68	Inman	Cora, Mrs.
15	11A	06	Evans	R. B.	15	05B	66	Harrison	C. J. (Clarence, Sr.)	15	06B	70	Inman	J. M. (James Madison)
15	11A	08	Evans	Robert	15	05B	68	Harrison	C. J. Jr. (Clarence)	15	07B	66	Inman	Jacquiline (Louise)
15	10B	52	Evans	Thelma	15	05B	67	Harrison	Floy (Lindel Shearin)	15	06B	71	Inman	Lou (Venia Wilkinson)
15	05A	26	Flowers	Bertha (E. Jameson)	15	10A	32	Harvey	Edward (L.)	15	07B	64	Inman	Ralph
15	06B	66	Flowers	Darwin	15	10A	33	Harvey	Iva (J.)	15	07B	63	Inman	Roy
15	05A	25	Flowers	E. D. (Earnest)	15	01B	51	Harwell	Epsie	15	07B	67	Inman	Velta Mae (McNutt)
15	05A	29	Flowers	Harvey Earl (Eugene)	15	01B	47	Harwell	J. E. (Edgar J.)	15	07B	61	Inman	W. C. (Willie Cowan)
15	05A	28	Flowers	Laverne	15	01B	49	Harwell	Jerelene	15	02B	52	Jeffery	Charles (Evin)
15	08B	45	Forbes	Salena (R.)	15	01B	50	Harwell	Morris (Eugene)	15	02B	49	Jeffery	J. T. (James)
15	04A	40	Ford	Belfa	15	01B	52	Harwell	Myrtis ?	15	02B	51	Jeffery	Nettie Marie
15	05B	72	Ford	Bobbie Ray	15	01B	52	Harwell	Myrtis ?	15	02B	50	Jeffery	Roberta (Day)
15	08B	74	Ford	Dora	15	01B	48	Harwell	Velma (L. Brown)	15	02A	35	Jennings	Bernie
15	05B	70	Ford	Imarie	15	10A	03	Haynes	Jack	15	01B	74	Jennings	H. D. (Herbert Dodson)
15	08B	73	Ford	J. W. (Joseph)	15	10A	01	Haynes	Julia (Ferguson)	15	01B	77	Jennings	Herbert Wayne
15	05B	71	Ford	John	15	10A	02	Haynes	Wade	15	02A	37	Jennings	June (Deloris June)
15	04A	39	Ford	Lynndia	15	05B	55	Heard	John D.	15	02A	36	Jennings	Mattieleon (Mattie Leon Sims)
15	04A	37	Ford	M. M. (Marion Manley, Sr.)	15	08A	32	Heffington	Durwood	15	02A	34	Jennings	Naomi (N.)
15	04B	41	Ford	M.M. (Marion Manely Jr.)	15	10A	30	Helm	Barbara	15	01B	76	Jennings	Robert Glen
15	04A	38	Ford	Roberta	15	10A	06	Helm	Bennie (Bennie Earl)	15	02A	33	Jennings	T. O. (Tommie)
15	05B	69	Ford	W. G. (William Grady)	15	10A	29	Helm	Bernice	15	01B	75	Jennings	Tommie Lee (Brown)
15	05B	74	Freiley	Anna Lou	15	10A	05	Helm	Bernice (Fay Hanes)					
15	05B	73	Freiley	J. A.	15	10A	04	Helm	E. M. (Earl Monroe)					
15	05B	77	Freiley	Jack (Jeso H.)	15	10A	28	Helm	George					
					15	10A	31	Helm	Howard Lee					
					15	11A	03	Hiatt	Leone					

Index of Names for 1940 Wise County TX Census - ED 15 Newark Town & Area Around Boyd

(864 Names - 102 are in the Town of Newark)

ED	Page	Line	Last Name	Given Name	ED	Page	Line	Last Name	Given Name	ED	Page	Line	Last Name	Given Name
15	06B	67	Pillow	Robert	15	02B	80	Sanders	J. A.	15	09A	16	Smith	Imogene
15	04B	56	Pope	Dorothy Mae	15	02B	78	Sanders	Reed	15	05A	16	Smith	J. Frank
15	04B	54	Pope	Edith	15	03A	30	Sandlin	Anna	15	09A	21	Smith	Jackie Doyle
15	12A	31	Pope	Emma Elizabeth	15	03A	29	Sandlin	W. D.	15	04A	16	Smith	John (Posie Everett, Sr.)
15	04B	53	Pope	J.	15	07A	17	Scroggins	A. J. (Andrew Jackson)	15	04A	18	Smith	John Bob
15	04B	55	Pope	John	15	07A	19	Scroggins	A. W. (Andrew Wayne)	15	09A	18	Smith	Juannell
15	12A	28	Pope	Mildred (I.)	15	10B	71	Scroggins	Alma	15	03B	43	Smith	L. L. (Lewis)
15	12A	25	Pope	Minnie	15	07A	21	Scroggins	Andrew Jackson	15	05A	09	Smith	Letha Margret (Margaret)
15	12A	24	Pope	R. A. (Robert Alexander)	15	07B	60	Scroggins	Delbert (Eugene)	15	05A	13	Smith	Lizzie
15	12A	30	Pope	Robert Mark	15	07B	59	Scroggins	Delorice (Eleanore Findeisin)	15	04A	17	Smith	Lula Mae (Voiett)
15	12A	27	Pope	Robert P. (Pinkney)	15	07B	57	Scroggins	Eugene (no middle name)	15	09B	75	Smith	M. S., Mrs.
15	12A	29	Pope	Vernon Doyle	15	09B	48	Scroggins	H. D. (Hamilton "Ham")	15	09A	13	Smith	Mae (Lydia May Swinney)
15	09B	74	Rainey	Alice	15	07A	24	Scroggins	Jackson Glen	15	05A	15	Smith	Margret (Margaret)
15	09B	73	Rainey	J. H.	15	07A	23	Scroggins	James Lee	15	09B	66	Smith	Mattie (M. May)
15	04B	73	Randolph	Albert (Lee)	15	07A	22	Scroggins	Joyce Ann	15	02A	15	Smith	Mollie
15	04B	72	Randolph	Annie (Brown)	15	07B	58	Scroggins	Mildred (Edith Lynch)	15	05A	17	Smith	Nettie
15	04B	75	Randolph	Corrine	15	07A	18	Scroggins	Ora B. (Oradell Cornstubble)	15	06B	54	Smith	Opal Faye
15	04B	76	Randolph	L. B.	15	07A	20	Scroggins	Roberta (Lee Kirkland)	15	05A	11	Smith	Ruby Faye
15	04B	71	Randolph	W. B. (William Blake)	15	09B	49	Scroggins	Vera Lee	15	05A	10	Smith	Vela Viola
15	04B	74	Randolph	William (M.)	15	01A	23	Seals	C. W. (Colonel)	15	09B	68	Smith	Verna Ruth
15	06A	34	Raspberry	J. R.	15	01A	25	Seals	Jettielee	15	05A	20	Smith	Vonna Rey
15	06A	02	Ratliff	C. T. (Calvin)	15	01A	26	Seals	Joyce	15	06B	50	Smith	W. E. (William Edward)
15	06A	35	Ratliff	D. W. (Derrick)	15	01A	24	Seals	Lois (M. Tribble)	15	09B	65	Smith	W. T. (Walter Thomas)
15	06A	03	Ratliff	Paralee (F.)	15	01B	62	Shimfr	Cassie (Castine Ella Brown)	15	05A	18	Smith	Wayne
15	05B	53	Read	Barbara Ann	15	01B	64	Shimfr	Catherine (Cathrine Alberta)	15	04B	77	Splawn	G. E.
15	05B	52	Read	Bertha Lee (Darwin)	15	01B	63	Shimfr	Louella (Caslene Luella)	15	04B	79	Splawn	Imogene
15	05B	54	Read	Elaine (Doris Elaine)	15	01B	61	Shimfr	T. L. (Taft Lafayette)	15	04B	78	Splawn	Mollie
15	05B	51	Read	Wayne (Norbert)	15	01A	32	Simpson	Onell (A. O. Alexander)	15	07B	44	Stanford	Bessie (Patterson)
15	02A	22	Reeves	Johnnie Lee	15	01A	34	Simpson	Vernon	15	07B	48	Stanford	Betty (Jo)
15	02A	21	Reeves	Lee (Sr.)	15	01A	33	Simpson	Virgie Lee (Virgale See)	15	07B	45	Stanford	Clifford
15	02A	24	Reeves	Lee, Jr.	15	01A	31	Simpson	Yovell	15	07B	46	Stanford	Harold
15	02A	23	Reeves	Virginia	15	10A	34	Slimp	Alice (Harvey)	15	07B	49	Stanford	Joe
15	03B	68	Reid	Albert	15	10A	35	Slimp	Glenda	15	07B	47	Stanford	Roy
15	06B	69	Reynolds	Eugene	15	03B	44	Smith	Agnes (A.)	15	07B	50	Stanford	Ruth
15	12A	37	Rickman	Billy (Edwin)	15	06B	53	Smith	Alice Pearl	15	07B	52	Stanford	Vera (Lucille)
15	09A	06	Rickman	C. W. (Charles)	15	09A	14	Smith	Annavell	15	07B	51	Stanford	Yvonne
15	12A	39	Rickman	Jo Ann	15	09B	67	Smith	Arvil	15	05B	49	Stantzenberger	Aubrey K.
15	12A	38	Rickman	Lois (N.)	15	06B	52	Smith	Bernice	15	05B	48	Stantzenberger	Garvis
15	12A	36	Rickman	Maude (A. Buck)	15	09A	15	Smith	Bernice	15	12A	03	Stephens	C. C. (Charlie)
15	09A	08	Rickman	Roberta	15	04A	19	Smith	Billy	15	12A	04	Stephens	Lorene
15	09A	07	Rickman	Rose (Roseta M.)	15	09A	19	Smith	Billy (Gilford)	15	12A	05	Stephens	Thomas
15	12A	35	Rickman	W. E. (William Edward)	15	09A	20	Smith	Charles Ray	15	12A	12	Stokes	Adrian
15	08A	23	Roberson	A. R. (Albert Ray "Dick")	15	05A	08	Smith	D. M. (David Milford)	15	02A	17	Stokes	Bernice
15	08A	24	Roberson	Frances (Cozby)	15	06B	57	Smith	Dora	15	12A	13	Stokes	Billy Charles
15	10A	27	Roberts	Eula	15	06B	56	Smith	E. J., Mrs.	15	12A	16	Stokes	J. R. (Jim)
15	08B	46	Robertson/Robinson	Myrtle	15	09A	17	Smith	E. L. (Elgin Lee, Jr.)	15	02A	16	Stokes	John
15	08B	48	Robinson/Robertson	Marvin (C.)	15	09A	12	Smith	E. L. (Elgin Lee, Sr.)	15	12A	15	Stokes	Kenneth
15	13A	01	Rogers	A. L. (Alva Lee)	15	05A	19	Smith	Estelline	15	12A	14	Stokes	Mirron Lee (Marion)
15	02A	26	Rogers	Ethel (Isbell)	15	05A	12	Smith	Ester Bell	15	12A	11	Stokes	Oscar (A.)
15	02A	25	Rogers	L.A. (Lee Ambers)	15	05A	14	Smith	Eva Mae	15	02A	18	Stokes	Robert M.
15	02A	27	Rogers	Marjorie (Louise)	15	08A	04	Smith	G. E.	15	06A	25	Stone	Gene (Jeanne)
15	13A	02	Rogers	Sudie (Mary Elizabeth George)	15	06B	55	Smith	George Thomas	15	04A	03	Sullivan	Anna Joe
15	01A	36	Ross	Florence	15	06B	51	Smith	Georgia	15	04A	05	Sullivan	Betty Sue
15	01A	35	Ross	Sam E.						15	04A	04	Sullivan	Billy Gene
15	11A	04	Royas	John						15	03B	80	Sullivan	E. V. (Eugene Victor)
15	11A	05	Royas	Nanny						15	04A	01	Sullivan	Gladys
15	10B	80	Sampson	Sabra						15	04A	06	Sullivan	Lola Mae
15	02B	79	Sanders	Della						15	04A	02	Sullivan	Onita

